

Property Name	KDX RESIDENCE NISHIAZABU	Unit No.	TYPE	Access	Roppongi Station on Oedo Line (9 min) Azabujuban Station on Namboku Line (15 min)
		202	Apt.		
Address	3-5-10, Nishiazabu, Minato-Ku, Tokyo				

Mid-rise Apt. in Nishiazabu, near Roppongi Hills & Arisugawa Park

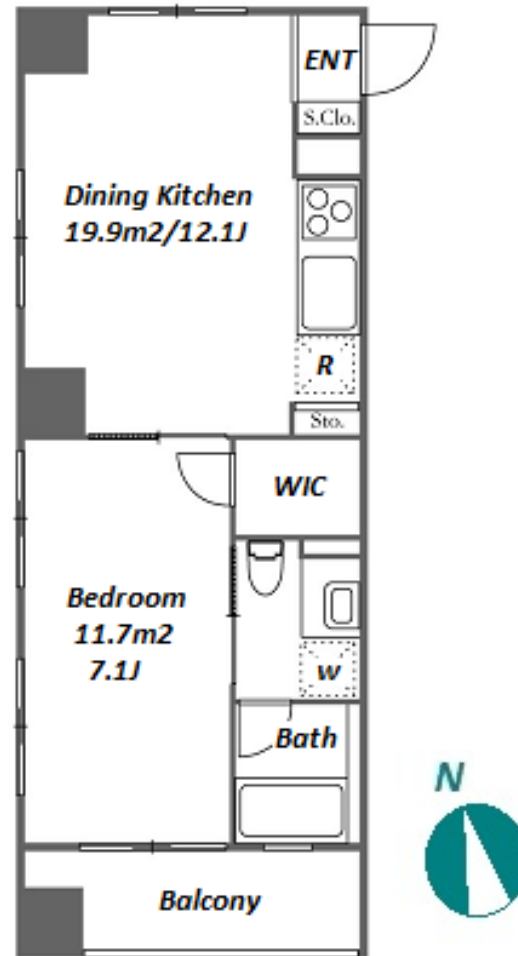

*The actual Layout & Size may differ slightly from this floor plans & pictures.

Lease Conditions	
LAYOUT	1 BR
SIZE	41.13 m²/442.71 ft²
RENT	JPY 190,000 / month
Management Fee	JPY10,000/month
Deposit	2 months
Key Money	1 month
Lease Term	Standard lease for 24 months
Available	End, Oct, 2024
Renewal Fee	1 month
Agent Fee	1 month + tax
Other Info	Key Replacement Fee : JPY18,000 Tax included / Guarantor Company : TBC / Auto lock / Air-Con / Separated Toilet / Balcony / Flooring / Washer / Dryer / WIC

Building Information	
Completion	Feb, 2008
Earthquake Resistance	New
Structure	RC, 14 floors above and 1 basement floors
Car Parking	JPY50,000 + tax / month
Bicycle Parking	N/A
Music Instrument	-
Pet	N/A
Facilities	Motorcycle Parking (TBC) / Within 20 min walk to Roppongi / Within 20 min to Roppongi by train / Near Large Parks / Delivery box / Elevator / Security

Remarks
Renters Insurance : Required



HOUSEREP TOKYO INC.

ハウスレップトーキョー株式会社

#301, 1-4-15, Hiroo, Shibuya-ku, Tokyo 150-0012, Japan

+81 (0)3 6427 5860

inquiry@housserrep-tokyo.com

Transaction Type : Intermediate

Agent Fee : 1 month + tax

Website : www.housserrep-tokyo.com

