

Property Name	RESIDIA SHIMAZUYAMA	Unit No.	TYPE	Access	Takanawadai Station on Toei Asakusa Line (5 min) Gotanda Station on JR Yamanote Line (7 min)
		1301	Apt.		
Address	1-2-42, Higashigotanda, Shinagawa-Ku, Tokyo				

Mid-rise Apt. in Shimazuyama, near Shinagawa / Gotanda

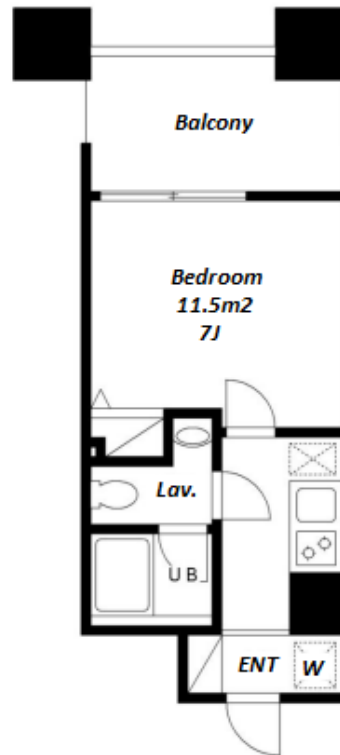

Lease Conditions		
LAYOUT	Studio	
SIZE	23.67 m ² /254.78 ft ²	
RENT	JPY 135,000 / month	
Management Fee	JPY 10,000/month	
Deposit	2 months	Key Money -
Lease Term	Standard lease for 24 months	
Available	Negotiable	
Renewal Fee	1 month	
Agent Fee	1 month + tax	
Other Info	Key Replacement Fee : JPY20,000 Tax not included / Guarantor Company : TBC / No Key Money / Auto lock / Renovated / Air-Con / Separated Toilet / Balcony / Internet (Extra Charge) / Penalty Fee for Early Cancellation / CS/CATV / Flooring / Bathroom dryer / Corner Unit	

Building Information			
Completion	Dec, 2004	Earthquake Resistance	New
Structure	RC, 13 floors above		
Car Parking	N/A		
Bicycle Parking	TBC		
Music Instrument	-	Pet	N/A
Facilities	Within 20 min to Tokyo station by car / Near Large Parks / Delivery box / Elevator		

Remarks
Tenant membership fee: JPY.10,000+tax/2years Internet Access: JPY.1,500+tax/month

*The actual Layout & Size may differ slightly from this floor plans & pictures.



HOUSEREP TOKYO INC.

ハウスレップトーキョー株式会社

#301, 1-4-15, Hiroo, Shibuya-ku, Tokyo 150-0012, Japan

+81 (0)3 6427 5860

inquiry@housserrep-tokyo.com

Transaction Type : Intermediate

Agent Fee : 1 month + tax

Website : www.housserrep-tokyo.com

