

Property Name	AZABU GARDENS EAST	Unit No.	TYPE	Access	Azabujuban Station on Namboku Line (8 min) Azabujuban Station on Oedo Line (8 min) Ropponngi Station on Hibiya Line (11 min)
		201	Apt.		
Address	3-7-10, Motoazabu, Minato-Ku, Tokyo				

Luxury Residence in the most desirable neighborhood "Motoazabu"

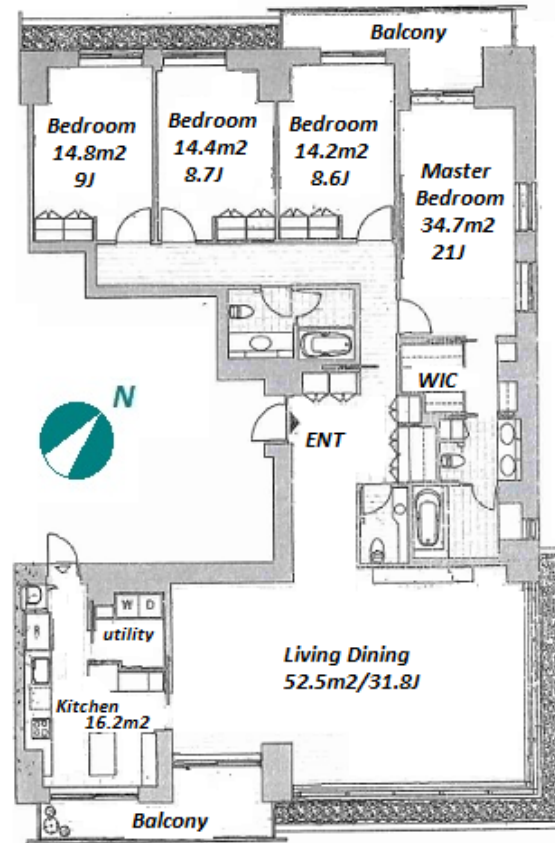

*The actual Layout & Size may differ slightly from this floor plans & pictures.

Lease Conditions	
LAYOUT	4 BR
SIZE	186.7 m ² /2009.62 ft ²
RENT	JPY 2,100,000 / month
Management Fee	-
Deposit	4 months
Key Money	-
Lease Term	Fixed term lease for 24 months
Available	Now
Renewal Fee	-
Agent Fee	1 month + tax
Other Info	Auto lock / Fridge / Air-Con / Separated Toilet / Balcony / Penalty Fee for Early Cancellation / 2+ bathrooms / Flooring / Floor Heating / Washer / Dryer / Dishwasher / Oven / WIC / Corner Unit / 2 Toilets

Building Information			
Completion	Feb, 2010	Earthquake Resistance	New
Structure	RC, 5 floors above and 2 basement floors		
Car Parking	for 1 space (Included)		
Bicycle Parking	TBC		
Music Instrument	-	Pet	Negotiable
Facilities	Motorcycle Parking (TBC) / Trunk Room (TBC) / Gym ((Included)) / Within 20 min walk to Roppongi / Within 20 min to Roppongi by train / Near Large Parks / Concierge / Elevator / Low-rise		

Remarks
Renters Insurance : Required



HOUSEREP TOKYO INC.

ハウスレップトーキョー株式会社

#301, 1-4-15, Hiroo, Shibuya-ku, Tokyo 150-0012, Japan

+81 (0)3 6427 5860

inquiry@housserep-tokyo.com

Transaction Type : Intermediate

Agent Fee : 1 month + tax

Website : www.housserep-tokyo.com

