

Property Name	PARK ROUGE AKASAKA HINOKICHO	Unit No.	TYPE	Access	Nogizaka Station on Chiyoda Line (5 min) Akasaka Station on Chiyoda Line (7 min) Ropponngi Station on Oedo Line (10 min)
		501	Apt.		
Address	7-11-12, Akasaka, Minato-Ku, Tokyo				

Stylish Apt. in Akasaka/Roppongi, near Tokyo Mid Town

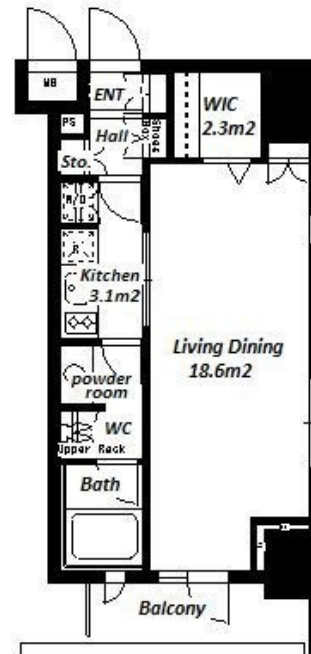
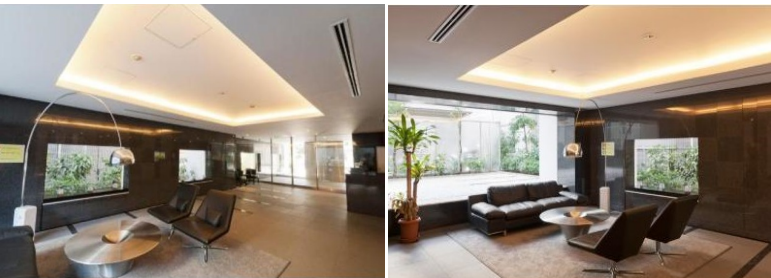

Lease Conditions		
LAYOUT	Studio	
SIZE	35.34 m ² /380.39 ft ²	
RENT	JPY 167,000 / month	
Management Fee	JPY8,000/month	
Deposit	2 months	Key Money -
Lease Term	Standard lease for 24 months	
Available	End, Jun, 2024	
Renewal Fee	1 month	
Agent Fee	1 month + tax	
Other Info	No Key Money / Auto lock / Fridge / Air-Con / Separated Toilet / Balcony / Penalty Fee for Early Cancellation / Oven	

Building Information		
Completion	Feb, 2005	Earthquake Resistance New
Structure	RC, 14 floors above and 1 basement floors	
Car Parking	TBC	
Bicycle Parking	N/A	
Music Instrument	-	Pet Allowed
Facilities	Within 20 min walk to Roppongi / Within 20 min to Roppongi by train / Within 20 min to Tokyo station by car / Near Large Parks / Delivery box / Elevator / Close to Station	

*The actual Layout & Size may differ slightly from this floor plans & pictures.



HOUSEREP TOKYO INC.

ハウスレップトーキョー株式会社

#301, 1-4-15, Hiroo, Shibuya-ku, Tokyo 150-0012, Japan

+81 (0)3 6427 5860

inquiry@housserrep-tokyo.com

Transaction Type : Intermediate

Agent Fee : 1 month + tax

Website : www.housserrep-tokyo.com



Remarks
Renters Insurance : Required / Pet:additional deposit (1 month)