

FOR RENT

Property ID No. :38920

HOUSEREP TOKYO INC.

Website : www.houserep-tokyo.com

Property Name	LA TOUR SHINJUKU GRAND	Unit No.	TYPE	Access	Nishishinnjuku Station on Marunouchi Line (6 min) Tochoumae Station on Oedo Line (10 min) Shinnjuku Station on JR Yamanote Line (15 min)
		4001	Apt.		
Address	8-17-2, Nishishinjuku, Shinjuku-Ku, Tokyo				

## Luxury Tower Residence in Nishi-Shinjuku, near Central Park

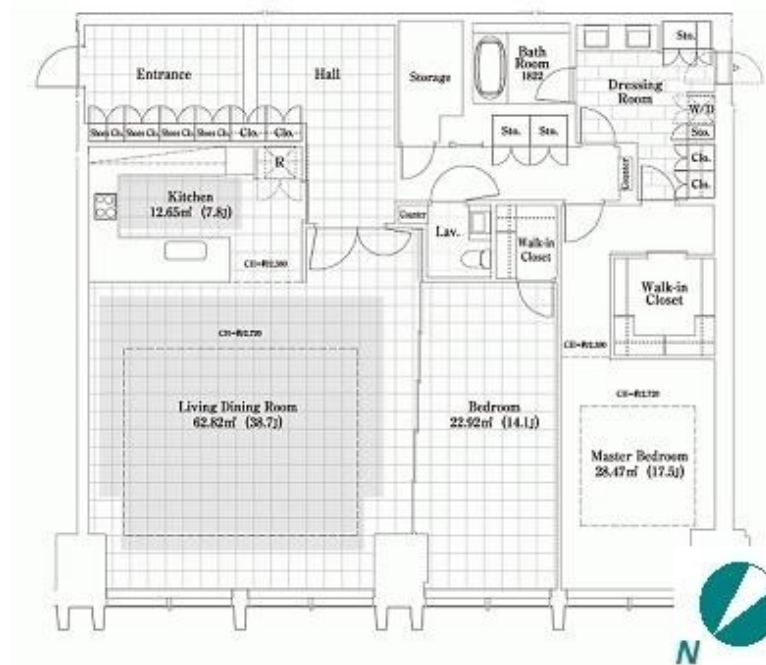

Lease Conditions		
LAYOUT	2 BR	
SIZE	194.98 m²/2098.74 ft²	
RENT	JPY 1,590,000 / month	
Management Fee	-	
Deposit	2 months	Key Money -
Lease Term	Fixed term lease for 36 months	
Available	Now	
Renewal Fee	-	
Agent Fee	1 month + tax	
Other Info	Depreciation : 1 month / No Key Money / Auto lock / Air-Con / Separated Toilet / Internet Included / Penalty Fee for Early Cancellation / Nice Views / Flooring / Floor Heating / Bathroom dryer / WIC / High Ceiling (above 2.5m)	

Building Information			
Completion	Sep, 2011	Earthquake Resistance	New
Structure	RC, SRC, 40 story		
Car Parking	TBC		
Bicycle Parking	TBC		
Music Instrument	-	Pet	Negotiable
Facilities	Motorcycle Parking (TBC) / Trunk Room (TBC) / Gym (( Included )) / Within 20 min walk to Roppongi / Within 20 min to Roppongi by train / Near Large Parks / Front desk / Concierge / Elevator / High-rise		

Remarks

\*The actual Layout & Size may differ slightly from this floor plans & pictures.



# HOUSEREP TOKYO INC.

ハウスレップトーキョー株式会社

#301, 1-4-15, Hiroo, Shibuya-ku, Tokyo 150-0012, Japan

+81 (0)3 6427 5860

inquiry@houserep-tokyo.com

Transaction Type : Intermediate

Agent Fee : 1 month + tax

Website : www.houserep-tokyo.com

