

Property Name	CAMELLIA COURT KAMIYAMACHO	Unit No.	TYPE	Access	Yoyogikouenn Station on Chiyoda Line (9 min) Yoyogihachimann Station on Odakyu Line (9 min) Shibuya Station on JR Yamanote Line (15 min)
		102	Apt.		
Address	33-6, Kamiyamacho, Shibuya-Ku, Tokyo				

Luxury Apt. in Quiet Residential Blocks of Shibuya, near "Yoyogi Park"

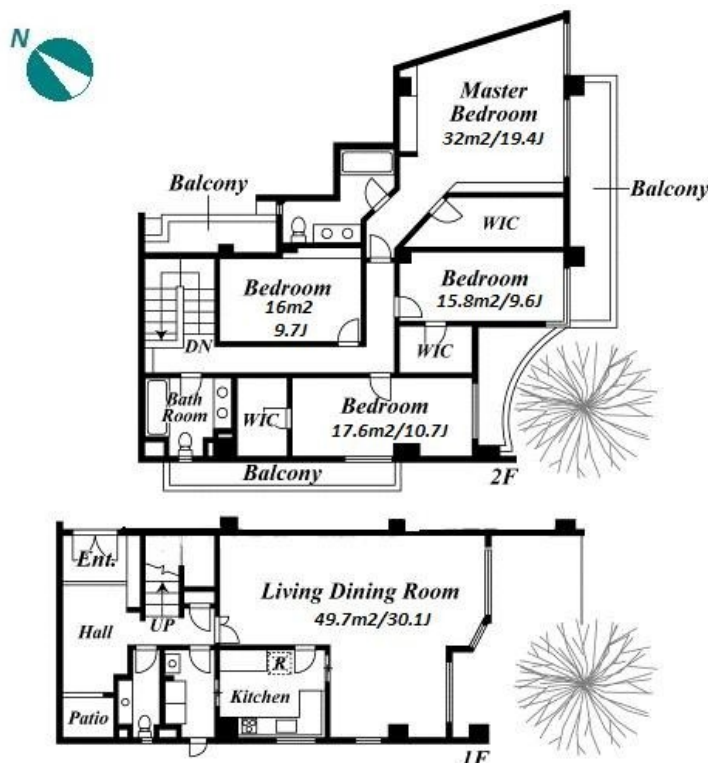

Lease Conditions	
LAYOUT	4 BR
SIZE	235.52 m ² /2535.11 ft ²
RENT	JPY 1,400,000 / month
Management Fee	-
Deposit	2 months
Key Money	-
Lease Term	Fixed term lease for 24 months
Available	Now
Renewal Fee	-
Agent Fee	1 month + tax
Other Info	Key Replacement Fee : JPY30,000 Tax not included / Guarantor Company : TBC / No Key Money / Auto lock / Renovated / Air-Con / Separated Toilet / Balcony / Loft/Maisonette / Musical Instrument Negotiable / 2+ bathrooms / Garden/Terrace / Carpet / Washer / Dryer / Dishwasher / Oven / Bathroom dryer / WIC

Building Information			
Completion	Jan, 2002	Earthquake Resistance	New
Structure	RC, 3 floors above		
Car Parking	for 1 space (Included)		
Bicycle Parking	(Included)		
Music Instrument	Negotiable	Pet	Allowed
Facilities	Motorcycle Parking (TBC) / Near Large Parks		

Remarks
Renters Insurance : Required / Pet:additional deposit (1 month)

*The actual Layout & Size may differ slightly from this floor plans & pictures.



HOUSEREP TOKYO INC.

ハウズレップトーキョー株式会社

#301, 1-4-15, Hiroo, Shibuya-ku, Tokyo 150-0012, Japan

+81 (0)3 6427 5860

inquiry@housserrep-tokyo.com

Transaction Type : Intermediate

Agent Fee : 1 month + tax

Website : www.housserrep-tokyo.com

