

Property Name	LA TOUR ICHIGAYA SADOHARA	Unit No.	TYPE	Access	Ichigaya Station on JR Chuo Line Rapid Service (7 min) Ushigomekagurazaka Station on Oedo Line (7 min) Iidabashi Station on JR Chuo Line Rapid Service (11 min)
		W201	Apt.		
Address	3-17-1, Ichigayasadoharacho, Shinjuku-Ku, Tokyo				

Luxury Low Rise Residence in Ichigaya / Kagurazaka

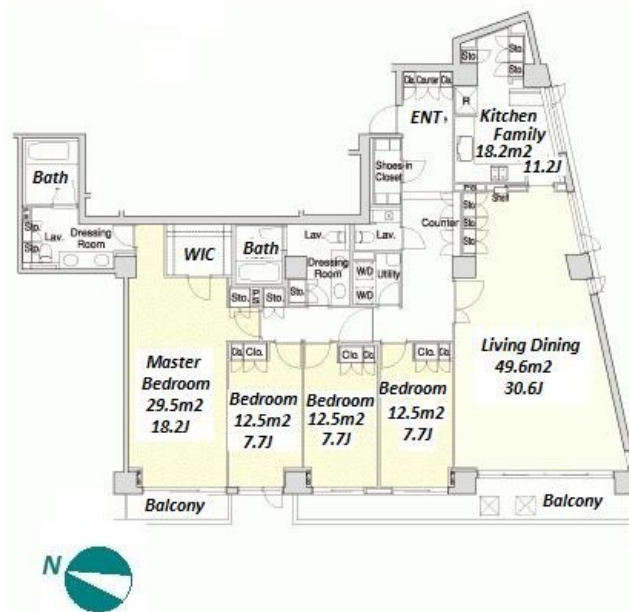

Lease Conditions		
LAYOUT	4 BR	
SIZE	201.5 m²/2168.92 ft²	
RENT	JPY 1,250,000 / month	
Management Fee	-	
Deposit	3 months	Key Money -
Lease Term	Fixed term lease for 36 months	
Available	Now	
Renewal Fee	-	
Agent Fee	1 month + tax	
Other Info	Depreciation : 1 month / Guarantor Company : TBC / No Key Money / Auto lock / Fridge / Air-Con / Separated Toilet / Balcony / Penalty Fee for Early Cancellation / 2+ bathrooms / Floor Heating / Washer / Dryer / Dishwasher / Oven / WIC / 2 Toilets	

Building Information			
Completion	Mar, 2007	Earthquake Resistance	New
Structure	RC, 5 story		
Car Parking	TBC		
Bicycle Parking	TBC		
Music Instrument	-	Pet	Allowed
Facilities	Motorcycle Parking (TBC) / Gym ((Included)) / Within 20 min to Tokyo station by car / Near Large Parks / French Community / Front desk / Elevator / Security / Low-rise		

*The actual Layout & Size may differ slightly from this floor plans & pictures.



HOUSEREP TOKYO INC.

ハウスレップトーキョー株式会社

#301, 1-4-15, Hiroo, Shibuya-ku, Tokyo 150-0012, Japan

+81 (0)3 6427 5860

inquiry@housserep-tokyo.com

Transaction Type : Intermediate

Agent Fee : 1 month + tax

Website : www.housserep-tokyo.com



Remarks
Renters Insurance : Required / Pet:additional deposit (1 month)