

Property Name	PARK CUBE MEGURO TOWER	Unit No.	TYPE	Access	Meguro Station on JR Yamanote Line (6 min) Meguro Station on Namboku Line (6 min) Meguro Station on Mita Line (6 min)
		2104	Apt.		
Address	2-2-2, Shimomeguro, Meguro-Ku, Tokyo				

Stylish High-rise Apt. along Meguro River

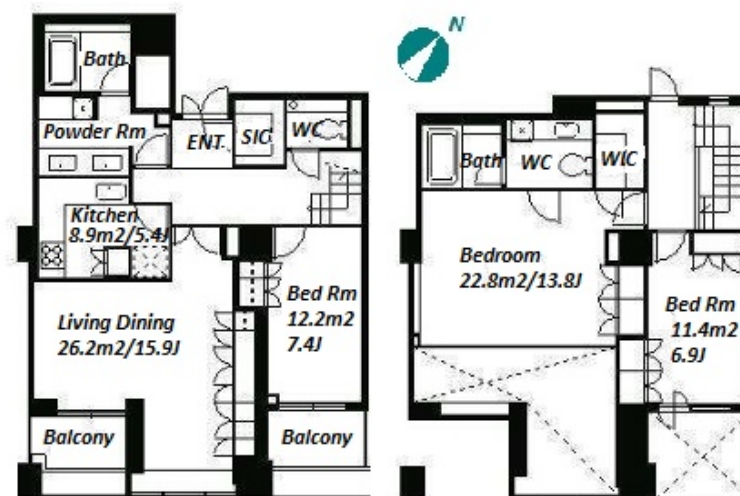

Lease Conditions		
LAYOUT	3 BR	
SIZE	145.81 m²/1569.48 ft²	
RENT	JPY 715,000 / month	
Management Fee	-	
Deposit	2 months	Key Money 1 month
Lease Term	Standard lease for 24 months	
Available	End, Aug, 2024	
Renewal Fee	1 month	
Agent Fee	1 month + tax	
Other Info	Key Replacement Fee : JPY15,000 Tax not included / Guarantor Company : TBC / Auto lock / Air-Con / Separated Toilet / Balcony / Loft/Maisonnette / Internet Included / Penalty Fee for Early Cancellation / 2+ bathrooms / Flooring / Floor Heating / Washer / Dryer / Dishwasher / Oven / Bathroom dryer / WIC / 2 Toilets	
Building Information		
Completion	Feb, 2008	Earthquake Resistance New
Structure	RC, 22 floors above and 2 basement floors	
Car Parking	JPY40,000 + tax / month	
Bicycle Parking	for 1 space (Included)	
Music Instrument	-	Pet N/A
Facilities	Motorcycle Parking (TBC) / Gym ((Included)) / Within 20 min to Roppongi by train / Near Large Parks / Front desk / Janitor / Delivery box / Elevator / Security / High-rise	

*The actual Layout & Size may differ slightly from this floor plans & pictures.



HOUSEREP TOKYO INC.

ハウスレップトーキョー株式会社

#301, 1-4-15, Hiroo, Shibuya-ku, Tokyo 150-0012, Japan

+81 (0)3 6427 5860

inquiry@housserrep-tokyo.com

Transaction Type : Intermediate

Agent Fee : 1 month + tax

Website : www.housserrep-tokyo.com



Remarks
Renters Insurance : Required / Bicycle parking : Registration sticker fee: JPY.2,000+tax