

|               |   |          |      |        |  |
|---------------|---|----------|------|--------|--|
| Property Name | MILIA RESIDENCE NOGIZAKA (MIRUM NOGIZAKA) | Unit No. | TYPE | Access | Nogizaka Station on Chiyoda Line (3 min)<br>Ropponngi Station on Oedo Line (13 min)<br>Ropponngi Station on Hibiya Line (15 min) |
|               |   | 206      | Apt. |        |  |
| Address       | 8-12-25, Akasaka, Minato-Ku, Tokyo        |          |      |        |  |

## Spacious Apartment Located between Roppongi and the Akasaka Area

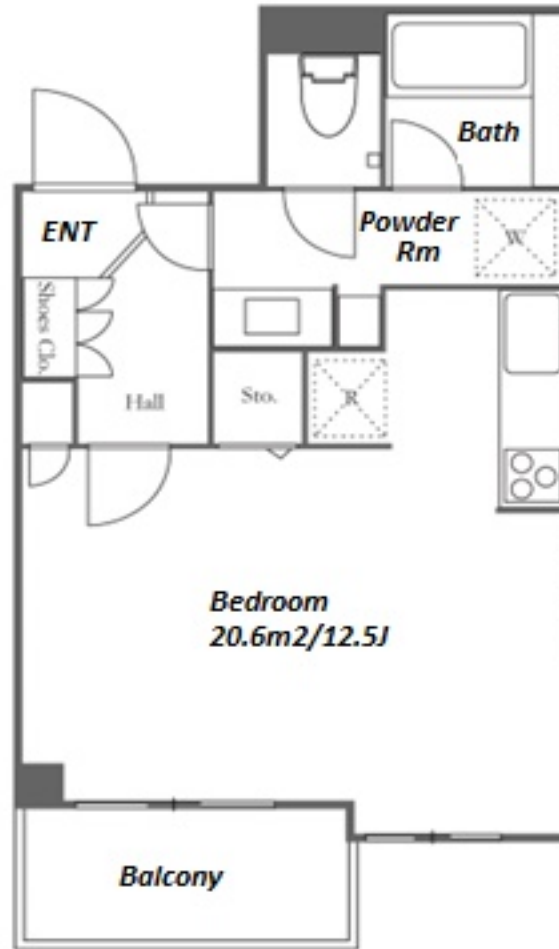

\*The actual Layout & Size may differ slightly from this floor plans & pictures.

| Lease Conditions |  |
|------------------|--|
| LAYOUT           | Studio   |
| SIZE             | 33.97 m <sup>2</sup> /365.65 ft <sup>2</sup>   |
| RENT             | JPY 188,000 / month  |
| Management Fee   | JPY10,000/month  |
| Deposit          | 1 month  |
| Key Money        | -  |
| Lease Term       | Standard lease for 24 months   |
| Available        | Now  |
| Renewal Fee      | 1 month  |
| Agent Fee        | 1 month + tax  |
| Other Info       | Key Replacement Fee : JPY18,000 Tax not included /<br>Guarantor Company : TBC / No Key Money / Auto lock<br>/ Air-Con / Separated Toilet / Balcony / Internet (Extra<br>Charge) / Penalty Fee for Early Cancellation / CS/CATV<br>/ Flooring / Dishwasher / Bathroom dryer / Corner Unit |

| Building Information |                                     |                       |     |
|----------------------|-------------------------------------|-----------------------|-----|
| Completion           | Jan, 2003                           | Earthquake Resistance | New |
| Structure            | RC, 6 floors above                  |                       |     |
| Car Parking          | TBC                                 |                       |     |
| Bicycle Parking      | N/A                                 |                       |     |
| Music Instrument     | -                                   | Pet                   | N/A |
| Facilities           | Trunk Room (JPY7,000 + tax / month) |                       |     |

| Remarks                      |
|------------------------------|
| Renters Insurance : Required |



# HOUSEREP TOKYO INC.

ハウスレップトーキョー株式会社

#301, 1-4-15, Hiroo, Shibuya-ku, Tokyo 150-0012, Japan

+81 (0)3 6427 5860

inquiry@housserep-tokyo.com

Transaction Type : Intermediate

Agent Fee : 1 month + tax

Website : www.housserep-tokyo.com

