

Property Name	IPSE MEGURONAKACHO	Unit No.	TYPE	Access	Yuutennji Station on Toyoko Line (7 min) Gakugeidaigaku Station on Toyoko Line (10 min)
		305	Apt.		
Address	2-49-12, Nakacho, Meguro-Ku, Tokyo				

Mid-rise Apt. in Yutenji, near Nakameguro / Ebisu

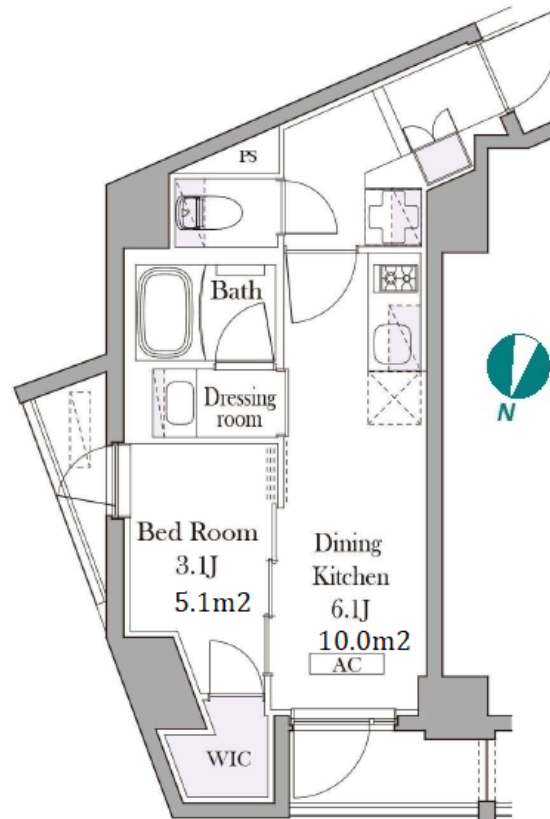

Lease Conditions	
LAYOUT	1 BR
SIZE	27.45 m ² /295.46 ft ²
RENT	JPY 136,000 / month
Management Fee	JPY10,000/month
Deposit	2 months
Key Money	1 month
Lease Term	Standard lease for 24 months
Available	End, Oct, 2024
Renewal Fee	1 month
Agent Fee	1 month + tax
Other Info	Key Replacement Fee : JPY20,000 Tax not included / Guarantor Company : TBC / Auto lock / Air-Con / Separated Toilet / Balcony / Internet Included / Flooring / Bathroom dryer / WIC

Building Information	
Completion	Aug, 2022
Earthquake Resistance	New
Structure	RC, 7 floors above
Car Parking	N/A
Bicycle Parking	for 1 space (Included)
Music Instrument	-
Pet	-
Facilities	Motorcycle Parking (JPY5,000 + tax / month) / Janitor / Delivery box / Elevator / Newly-built (~7 y/o)

Remarks
Renters Insurance : Required

*The actual Layout & Size may differ slightly from this floor plans & pictures.



HOUSEREP TOKYO INC.

ハウスレップトーキョー株式会社

#301, 1-4-15, Hiroo, Shibuya-ku, Tokyo 150-0012, Japan

+81 (0)3 6427 5860

inquiry@housserrep-tokyo.com

Transaction Type : Intermediate

Agent Fee : 1 month + tax

Website : www.housserrep-tokyo.com

