

Property Name	SEASON FLATS ASAKUSA KOTOTOI	Unit No.	TYPE	Access	Asakusa Station on (5 min) Asakusa Station on GINZA Line (10 min)
	DORI	401	Apt.		
Address	3-7-2, Asakusa, Taito-Ku, Tokyo				

Mid rise apartment in TOKYO near Asakusa Sta.

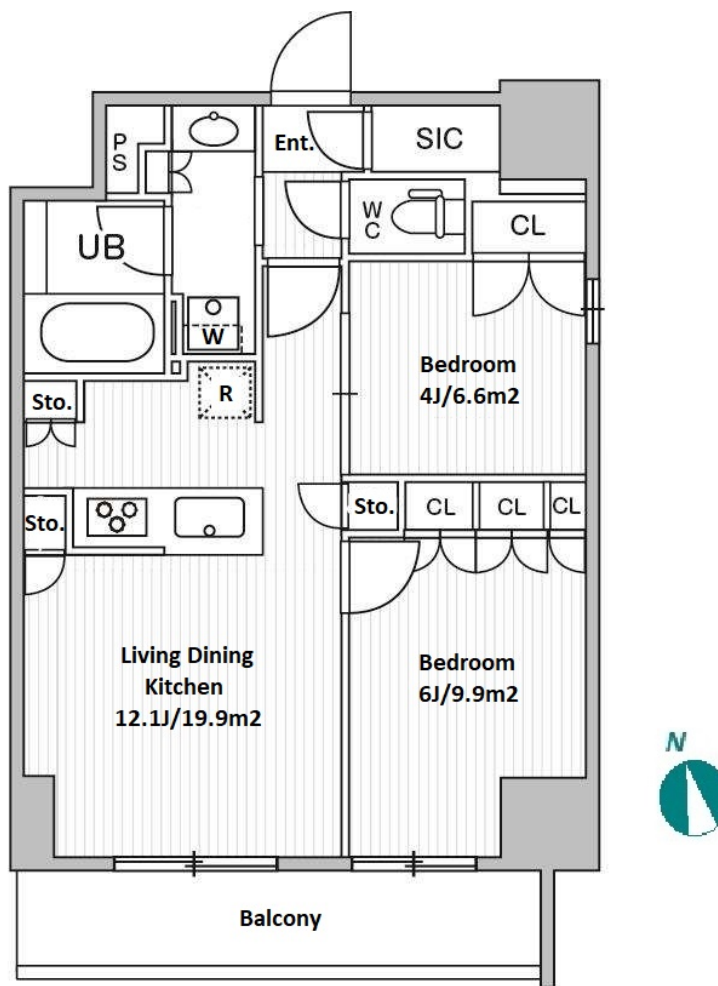

*The actual Layout & Size may differ slightly from this floor plans & pictures.

Lease Conditions		
LAYOUT	2 BR	
SIZE	51.66 m ² /556.06 ft ²	
RENT	JPY 259,000 / month	
Management Fee	JPY20,000/month	
Deposit	1 month	Key Money -
Lease Term	Standard lease for 24 months	
Available	Now	
Renewal Fee	1 month	
Agent Fee	1 month + tax	
Other Info	Guarantor Company : TBC / No Key Money / Free rent / Auto lock / Air-Con / Separated Toilet / Balcony / Penalty Fee for Early Cancellation / Flooring / Bathroom dryer	

Building Information			
Completion	Jun, 2024	Earthquake Resistance	New
Structure	RC, 13 floors above		
Car Parking	TBC		
Bicycle Parking	TBC		
Music Instrument	-	Pet	N/A
Facilities	Motorcycle Parking (TBC) / Janitor / Delivery box / Elevator / Security / Close to Station / Newly-built (~1 y/o)		

Remarks
Renters Insurance : Required



HOUSEREP TOKYO INC.

ハウスレップトーキョー株式会社

#301, 1-4-15, Hiroo, Shibuya-ku, Tokyo 150-0012, Japan

+81 (0)3 6427 5860

inquiry@housserrep-tokyo.com

Transaction Type : Intermediate

Agent Fee : 1 month + tax

Website : www.housserrep-tokyo.com

