

Property Name	PEAKS KANDA	Unit No.	TYPE	Access	Shinnihonbashi Station on JR Sobu Line (4 min) Kanda Station on JR Yamanote Line (5 min) Mitsukoshimae Station on Ginza Line (8 min)
		605	Apt.		
Address	4-7, Kandanishifukudacho, Chiyoda-Ku, Tokyo				

Mid-rise in Kanda, near Nihombashi

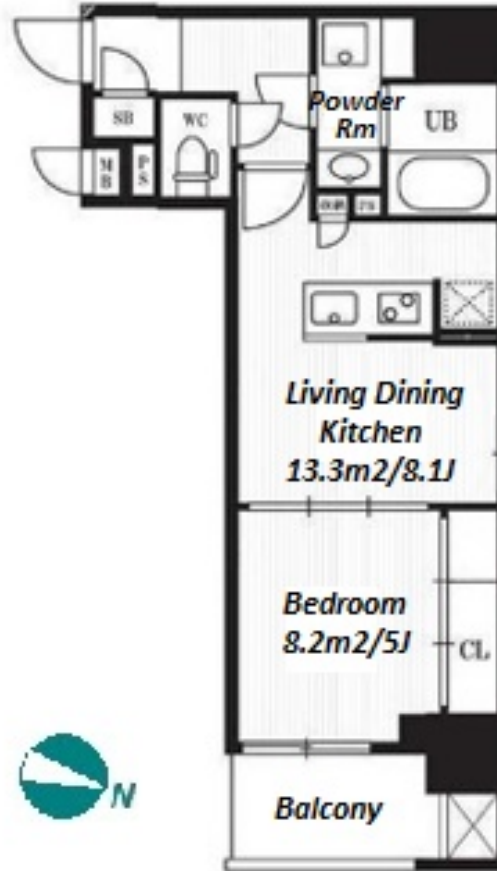
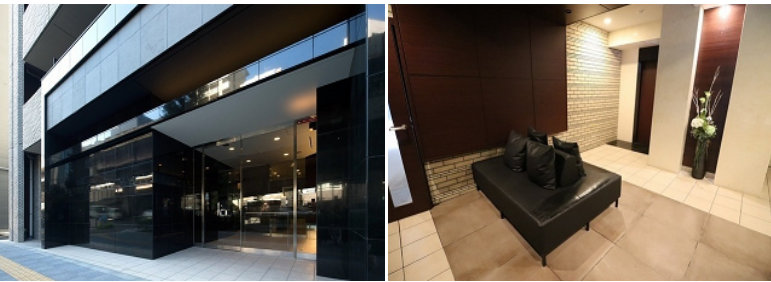

Lease Conditions	
LAYOUT	1 BR
SIZE	35.74 m²/384.7 ft²
RENT	JPY 169,000 / month
Management Fee	JPY10,000/month
Deposit	2 months
Key Money	-
Lease Term	Standard lease for 24 months
Available	End, Oct, 2024
Renewal Fee	1 month
Agent Fee	1 month + tax
Other Info	Key Replacement Fee : JPY20,000 Tax not included / Guarantor Company : TBC / No Key Money / Auto lock / Air-Con / Separated Toilet / Balcony / Internet Included / Penalty Fee for Early Cancellation / Flooring / Bathroom dryer

Building Information			
Completion	Jul, 2017	Earthquake Resistance	New
Structure	RC, 14 floors above		
Car Parking	extra charge		
Bicycle Parking	JPY300 + tax / month		
Music Instrument	-	Pet	Allowed
Facilities	Within 20 min to Tokyo station by car / Janitor / Delivery box / Elevator		

Remarks
Renters Insurance : Required / Pet:additional deposit (1 month) / Pet : a small dog or a cat

*The actual Layout & Size may differ slightly from this floor plans & pictures.



HOUSEREP TOKYO INC.

ハウスレップトーキョー株式会社

#301, 1-4-15, Hiroo, Shibuya-ku, Tokyo 150-0012, Japan

+81 (0)3 6427 5860

inquiry@housserrep-tokyo.com

Transaction Type : Intermediate

Agent Fee : 1 month + tax

Website : www.housserrep-tokyo.com

