

Property Name	RIVER CITY 21 EAST TOWERS 6	Unit No.	TYPE	Access	Tsukishima Station on Yurakucho Line (5 min) Tsukishima Station on Oedo Line (5 min) Hacchoubori Station on JR Keiyo Line (14 min)
		1302	Apt.		
Address	2-2-6, Tsukuda, Chuo-Ku, Tokyo				

High-rise residence in Tsukishima, near Sumida River

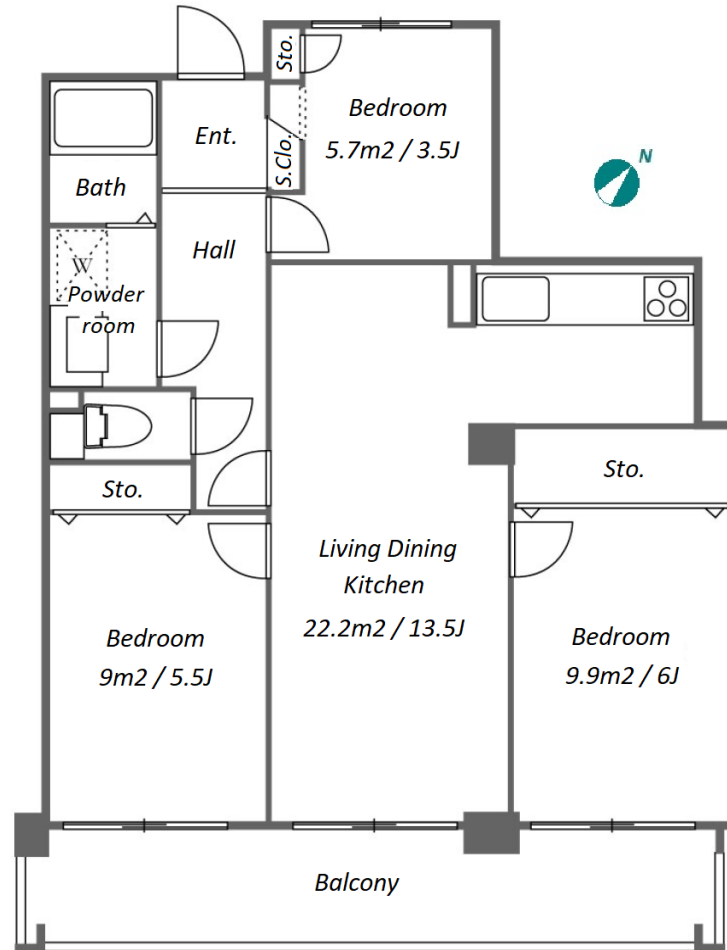

*The actual Layout & Size may differ slightly from this floor plans & pictures.

Lease Conditions	
LAYOUT	3 BR
SIZE	70.87 m ² /762.83 ft ²
RENT	JPY 259,000 / month
Management Fee	JPY10,000/month
Deposit	2 months
Key Money	-
Lease Term	Standard lease for 24 months
Available	Mid, Oct, 2024
Renewal Fee	1 month
Agent Fee	1 month + tax
Other Info	Key Replacement Fee : JPY15,000 Tax not included / Guarantor Company : TBC / No Key Money / Auto lock / Renovated / Air-Con / Separated Toilet / Balcony / Internet (Extra Charge) / Penalty Fee for Early Cancellation / Nice Views / CS/CATV / Flooring / Floor Heating / Bathroom dryer / High Ceiling (above 2.5m) / 2 Car Parks

Building Information			
Completion	Apr, 1988	Earthquake Resistance	New
Structure	SRC, 13 floors above		
Car Parking	JPY30,000 + tax / month		
Bicycle Parking	TBC		
Music Instrument	-	Pet	N/A
Facilities	Motorcycle Parking (TBC) / Trunk Room (TBC) / Near Large Parks / Janitor / Delivery box / Elevator / Security / Close to Station		

Remarks
Renters Insurance : Required / Parking : 3months deposit



HOUSEREP TOKYO INC.

ハウスレップトーキョー株式会社

#301, 1-4-15, Hiroo, Shibuya-ku, Tokyo 150-0012, Japan

+81 (0)3 6427 5860

inquiry@housserrep-tokyo.com

Transaction Type : Intermediate

Agent Fee : 1 month + tax

Website : www.housserrep-tokyo.com

