

Property Name	COURT LUXURIA NINGYOCHO	Unit No.	TYPE	Access	Ninngyouchou Station on Hibiya Line (2 min) Ninngyouchou Station on Toei Asakusa Line (2 min)
		806	Apt.		
Address	1-7-4, Nihombashiningyocho, Chuo-Ku, Tokyo				

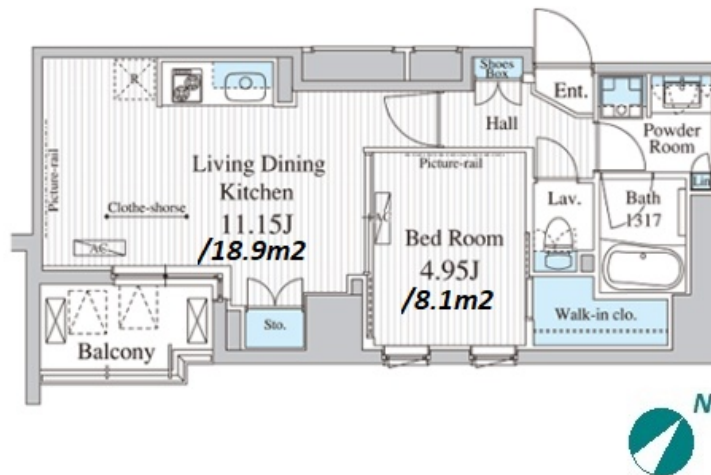
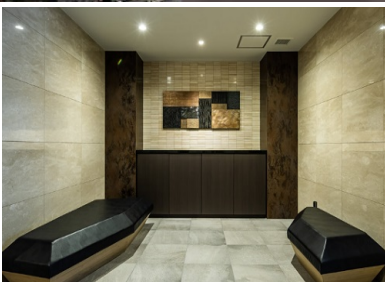
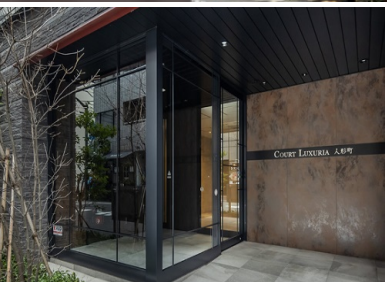

Lease Conditions

LAYOUT	1 BR		
SIZE	41.86 m²/450.57 ft²		
RENT	JPY 180,000 / month		
Management Fee	JPY10,000/month		
Deposit	2 months	Key Money	1 month
Lease Term	Standard lease for 24 months		
Available	End, Sep, 2024		
Renewal Fee	1 month		
Agent Fee	1 month + tax		
Other Info	Key Replacement Fee : JPY20,000 Tax not included / Guarantor Company : TBC / Auto lock / Air-Con / Separated Toilet / Balcony / Internet Included / Penalty Fee for Early Cancellation / Flooring / Bathroom dryer / WIC		

Building Information

Completion	Oct, 2016	Earthquake Resistance	New
Structure	RC, 10 floors above		
Car Parking	N/A		
Bicycle Parking	for 1 space (Included)		
Music Instrument	-	Pet	-

Facilities	Janitor / Delivery box / Elevator / Security / Close to Station
------------	---

Remarks

Remarks	Renters Insurance : Required
---------	------------------------------

*The actual Layout & Size may differ slightly from this floor plans & pictures.



HOUSEREP TOKYO INC.

ハウズレップトーキョー株式会社

#301, 1-4-15, Hiroo, Shibuya-ku, Tokyo 150-0012, Japan

+81 (0)3 6427 5860

inquiry@housserrep-tokyo.com

Transaction Type : Intermediate

Agent Fee : 1 month + tax

Website : www.housserrep-tokyo.com

