

Property Name	GRAND CASA MINOWA IV	Unit No.	TYPE	Access	Minamisennju Station on Hibiya Line (6 min) Minowa Station on Hibiya Line (8 min)
		1501	Apt.		
Address	2-26-7, Minamisenju, Arakawa-Ku, Tokyo				

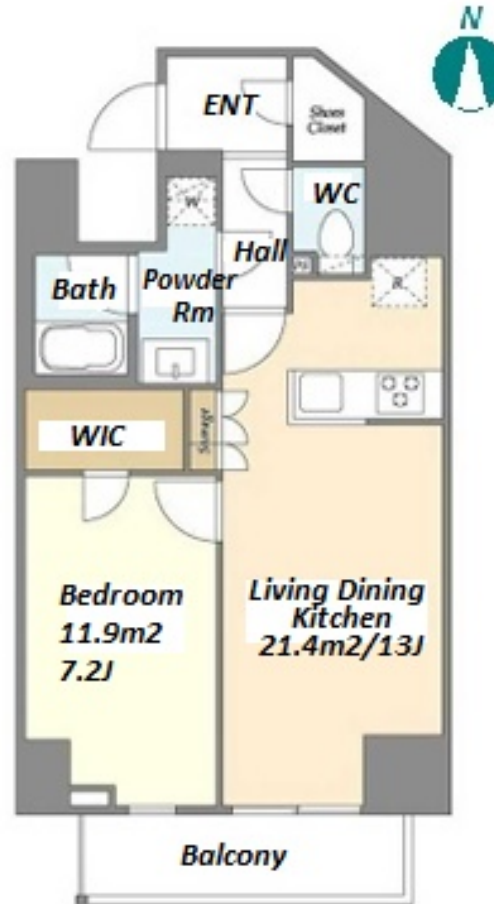

*The actual Layout & Size may differ slightly from this floor plans & pictures.

Lease Conditions			
LAYOUT	1 BR		
SIZE	52.81 m²/568.44 ft²		
RENT	JPY 189,000 / month		
Management Fee	JPY10,000/month		
Deposit	2 months	Key Money	1 month
Lease Term	Standard lease for 24 months		
Available	End, Sep, 2024		
Renewal Fee	1 month		
Agent Fee	1 month + tax		
Other Info	Key Replacement Fee : JPY30,000 Tax not included / Guarantor Company : TBC / No Key Money / Auto lock / Air-Con / Separated Toilet / Balcony / Internet Included / Penalty Fee for Early Cancellation / Flooring / Bathroom dryer / WIC / Corner Unit		

Building Information			
Completion	Dec, 2023	Earthquake Resistance	New
Structure	RC, 15 floors above		
Car Parking	JPY25,000 + tax / month		
Bicycle Parking	JPY300 + tax / month		
Music Instrument	-	Pet	Allowed
Facilities	Janitor / Delivery box / Elevator / Security / 24h Garbage Drop-off		

Remarks	
Renters Insurance : Required / Pet:additional deposit (1 month) / Pet : a small dog or a cat	



HOUSEREP TOKYO INC.

ハウスレプトーキョー株式会社

#301, 1-4-15, Hiroo, Shibuya-ku, Tokyo 150-0012, Japan

+81 (0)3 6427 5860

inquiry@housserep-tokyo.com

Transaction Type : Intermediate

Agent Fee : 1 month + tax

Website : www.housserep-tokyo.com

