

Property Name	LA TOUR SHINJUKU GARDEN	Unit No.	TYPE	Access	Takadanobaba Station on JR Yamanote Line (7 min) Shinnookubo Station on JR Yamanote Line (10 min)
		3725	Apt.		
Address	3-8-3, Okubo, Shinjuku-Ku, Tokyo				

Luxury Tower Residence in Shinjuku area, near Korea Town

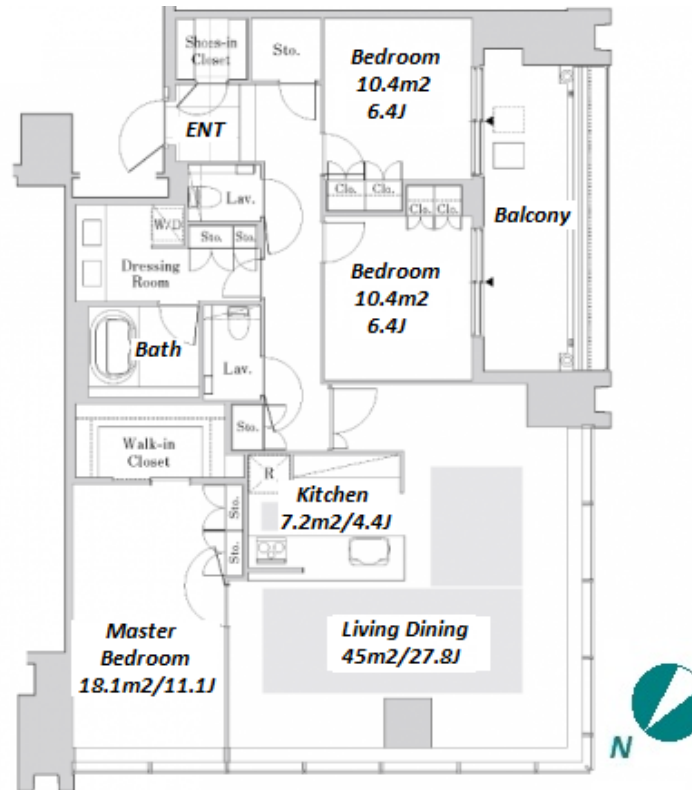

Lease Conditions	
LAYOUT	3 BR
SIZE	133.92 m²/1441.5 ft²
RENT	JPY 950,000 / month
Management Fee	-
Deposit	2 months
Key Money	-
Lease Term	Fixed term lease for 36 months
Available	Early, Nov, 2024
Renewal Fee	-
Agent Fee	1 month + tax
Other Info	Depreciation : 1 month / No Key Money / Air-Con / Separated Toilet / Balcony / Internet Included / Penalty Fee for Early Cancellation / Flooring / Floor Heating / WIC / 2 Toilets

Building Information			
Completion	Mar, 2016	Earthquake Resistance	New
Structure	SRC, 37 floors above and 2 basement floors		
Car Parking	JPY35,000 ~ 60,000/ month		
Bicycle Parking	extra charge		
Music Instrument	-	Pet	Negotiable
Facilities	Motorcycle Parking (TBC) / Trunk Room (extra charge) / Gym ((Included)) / Near Large Parks / Front desk / Concierge / Elevator / Sky lounge / High-rise		

Remarks

*The actual Layout & Size may differ slightly from this floor plans & pictures.



HOUSEREP TOKYO INC.

ハウスレップトーキョー株式会社

#301, 1-4-15, Hiroo, Shibuya-ku, Tokyo 150-0012, Japan

+81 (0)3 6427 5860

inquiry@housserrep-tokyo.com

Transaction Type : Intermediate

Agent Fee : 1 month + tax

Website : www.housserrep-tokyo.com

