

Property Name	PARK COURT SHIBUYA THE TOWER	Unit No.	TYPE	Access	Shibuya Station on Denentoshi Line (8 min) Shibuya Station on Keio Inokashira Line (9 min) Shibuya Station on JR Yamanote Line (9 min)
		1613	Apt.		
Address	1-12, Udagawacho, Shibuya-Ku, Tokyo				

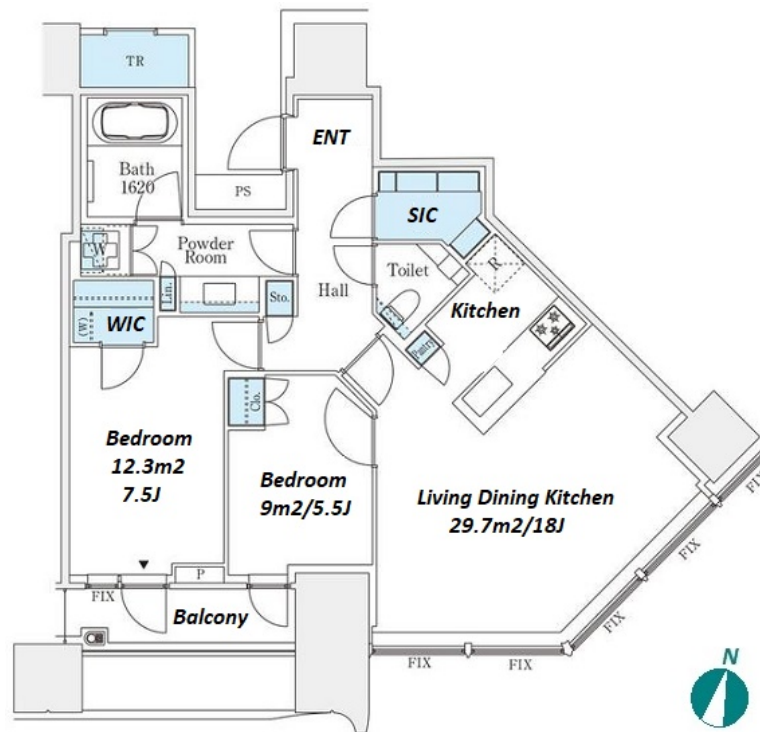
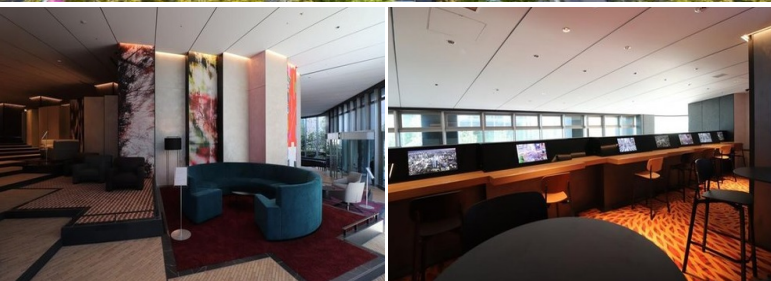

Lease Conditions		
LAYOUT	2 BR	
SIZE	74.46 m ² /801.48 ft ²	
RENT	JPY 652,000 / month	
Management Fee	JPY30,000/month	
Deposit	2 months	Key Money 1 month
Lease Term	Standard lease for 24 months	
Available	End, Nov, 2024	
Renewal Fee	1 month	
Agent Fee	1 month + tax	
Other Info	Auto lock / Air-Con / CS/CATV / Flooring / Floor Heating / Dishwasher / Private Yard	

Building Information		
Completion	Aug, 2020	Earthquake Resistance New
Structure	RC, 39 floors above and 4 basement floors	
Car Parking	N/A	
Bicycle Parking	for 1 space (Included)	
Music Instrument	-	Pet -
Facilities	Motorcycle Parking (extra charge) / Trunk Room (JPY3,150 + tax / month) / Near Large Parks / Front desk / Concierge / Janitor / Delivery box / Elevator / Security / 24h Garbage Drop-off / Fitness / Gym / High-rise / Newly-built (~7 y/o)	

Remarks
Renters Insurance : Required

*The actual Layout & Size may differ slightly from this floor plans & pictures.



HOUSEREP TOKYO INC.

ハウスレップトーキョー株式会社

#301, 1-4-15, Hiroo, Shibuya-ku, Tokyo 150-0012, Japan

+81 (0)3 6427 5860

inquiry@housserrep-tokyo.com

Transaction Type : Intermediate

Agent Fee : 1 month + tax

Website : www.housserrep-tokyo.com

