

Property Name	LA SANTE GOTANDA (GLENPARK G-WEST)	Unit No.	TYPE	Access	Oosakihirokouji Station on Tokyu Ikegami Line (5 min) Gotanda Station on JR Yamanote Line (9 min) Gotanda Station on Toei Asakusa Line (11 min)
		1401	Apt.		
Address	8-9-11, Nishigotanda, Shinagawa-Ku, Tokyo				

## High Quality Tower Residence in Gotanda / Shinagawa

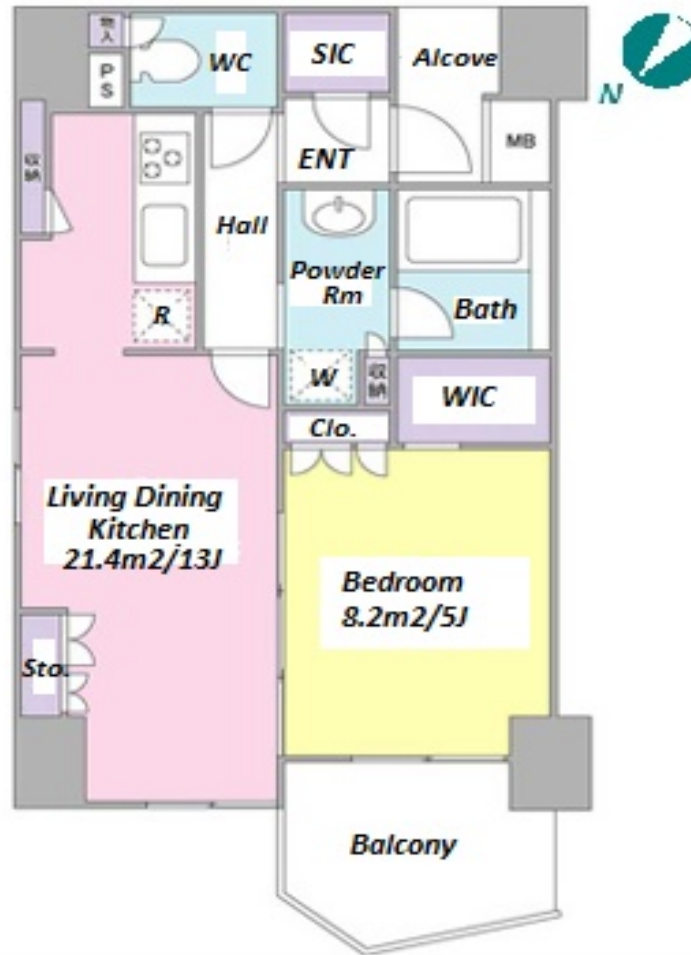

Lease Conditions		
LAYOUT	1 BR	
SIZE	44.97 m²/484.05 ft²	
RENT	JPY 219,000 / month	
Management Fee	JPY12,000/month	
Deposit	2 months	Key Money 1 month
Lease Term	Standard lease for 24 months	
Available	Early, Nov, 2024	
Renewal Fee	1 month	
Agent Fee	1 month + tax	
Other Info	Key Replacement Fee : JPY30,000 Tax not included / Guarantor Company : TBC / Auto lock / Air-Con / Separated Toilet / Balcony / Internet Included / Musical Instrument Negotiable / CS/CATV / Flooring / Floor Heating / Bathroom dryer / WIC	

Building Information			
Completion	Jan, 2006	Earthquake Resistance	New
Structure	RC, 15 floors above		
Car Parking	JPY30,000 + tax / month		
Bicycle Parking	for 1 space ( Included )		
Music Instrument	Negotiable	Pet	Allowed
Facilities	Motorcycle Parking (extra charge) / Delivery box		

\*The actual Layout & Size may differ slightly from this floor plans & pictures.



# HOUSEREP TOKYO INC.

ハウズレップトーキョー株式会社

#301, 1-4-15, Hiroo, Shibuya-ku, Tokyo 150-0012, Japan

+81 (0)3 6427 5860

inquiry@housserrep-tokyo.com

Transaction Type : Intermediate

Agent Fee : 1 month + tax

Website : www.housserrep-tokyo.com



Remarks	
Parking : 1 month deposit / Pet:additional deposit ( 1 month ) / Pet : a small dog or a cat	