

Property Name	LA SANTE GOTANDA (GLENPARK G-WEST)	Unit No.	TYPE	Access	Oosakihirokouji Station on Tokyu Ikegami Line (5 min) Gotanda Station on JR Yamanote Line (9 min) Gotanda Station on Toei Asakusa Line (11 min)
		1205	Apt.		
Address	8-9-11, Nishigotanda, Shinagawa-Ku, Tokyo				

## High Quality Tower Residence in Gotanda / Shinagawa

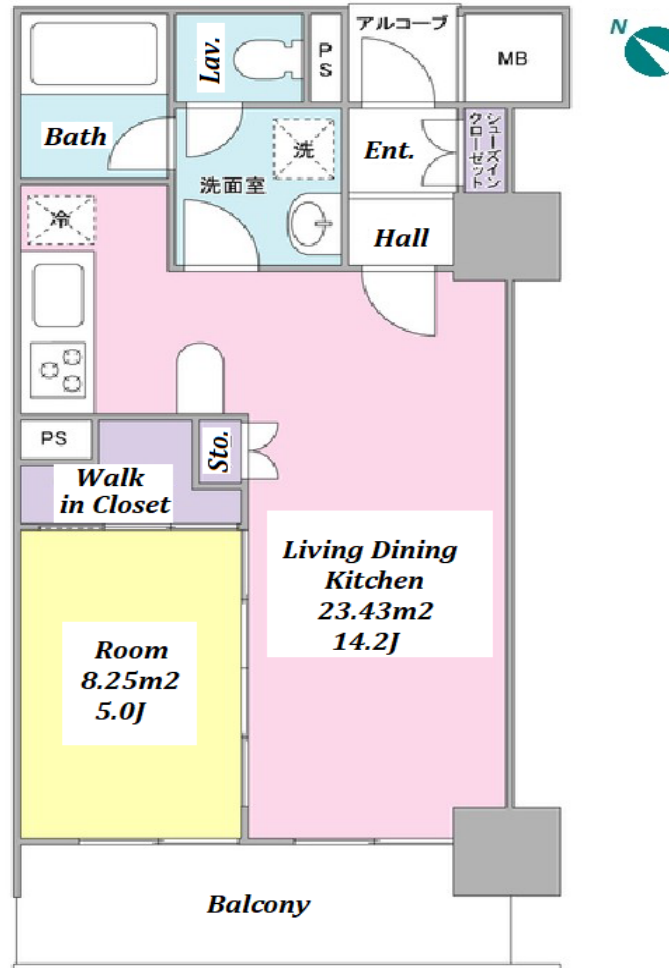

\*The actual Layout & Size may differ slightly from this floor plans & pictures.

Lease Conditions	
LAYOUT	1 BR
SIZE	45.19 m²/486.42 ft²
RENT	JPY 218,000 / month
Management Fee	JPY12,000/month
Deposit	2 months
Key Money	1 month
Lease Term	Standard lease for 24 months
Available	End, Oct, 2024
Renewal Fee	1 month
Agent Fee	1 month + tax
Other Info	Key Replacement Fee : JPY30,000 Tax not included / Guarantor Company : TBC / Auto lock / Air-Con / Separated Toilet / Balcony / Internet Included / Musical Instrument Negotiable / CS/CATV / Flooring / Floor Heating / Bathroom dryer / WIC

Building Information	
Completion	Jan, 2006
Earthquake Resistance	New
Structure	RC, 15 floors above
Car Parking	JPY30,000 + tax / month
Bicycle Parking	for 1 space ( Included )
Music Instrument	Negotiable
Pet	Allowed
Facilities	Motorcycle Parking (extra charge) / Delivery box

Remarks
Parking : 1 month deposit / Pet:additional deposit ( 1 month ) / Pet : a small dog or a cat



# HOUSEREP TOKYO INC.

ハウズレップトーキョー株式会社

#301, 1-4-15, Hiroo, Shibuya-ku, Tokyo 150-0012, Japan

+81 (0)3 6427 5860

inquiry@housserep-tokyo.com

Transaction Type : Intermediate

Agent Fee : 1 month + tax

Website : www.housserep-tokyo.com

