

Property Name	LA SANTE GOTANDA (GLENPARK G-WEST)	Unit No.	TYPE	Access	Oosakihirokouji Station on Tokyu Ikegami Line (5 min) Gotanda Station on JR Yamanote Line (9 min) Gotanda Station on Toei Asakusa Line (11 min)
		806	Apt.		
Address	8-9-11, Nishigotanda, Shinagawa-Ku, Tokyo				

## High Quality Tower Residence in Gotanda / Shinagawa

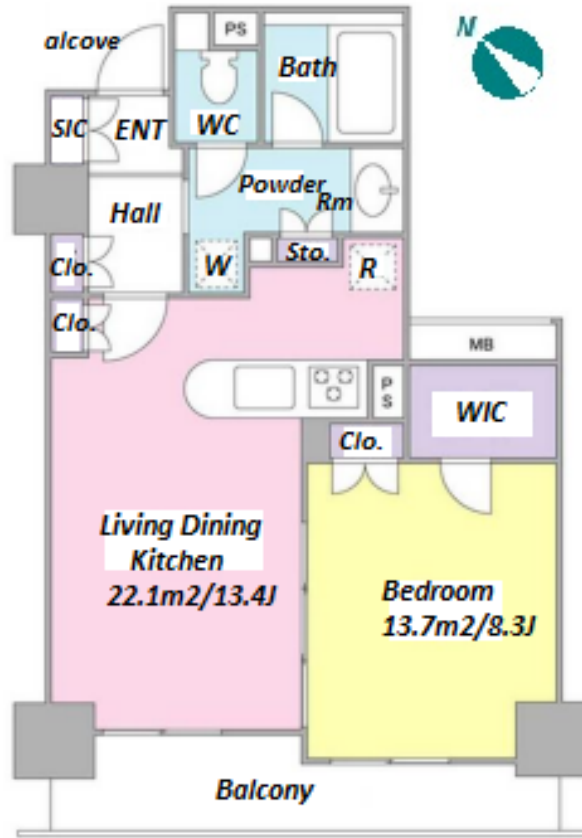

Lease Conditions	
LAYOUT	1 BR
SIZE	53.9 m²/580.17 ft²
RENT	JPY 237,000 / month
Management Fee	JPY13,000/month
Deposit	2 months
Key Money	-
Lease Term	Standard lease for 24 months
Available	End, Oct, 2024
Renewal Fee	1 month
Agent Fee	1 month + tax
Other Info	Key Replacement Fee : JPY30,000 Tax not included / Guarantor Company : TBC / No Key Money / Auto lock / Air-Con / Separated Toilet / Balcony / Internet Included / Penalty Fee for Early Cancellation / Musical Instrument Negotiable / CS/CATV / Flooring / Floor Heating / Bathroom dryer / WIC

Building Information			
Completion	Jan, 2006	Earthquake Resistance	New
Structure	RC, 15 floors above		
Car Parking	JPY30,000 + tax / month		
Bicycle Parking	for 1 space ( Included )		
Music Instrument	Negotiable	Pet	Allowed
Facilities	Motorcycle Parking (extra charge) / Delivery box		

\*The actual Layout & Size may differ slightly from this floor plans & pictures.



# HOUSEREP TOKYO INC.

ハウズレップトーキョー株式会社

#301, 1-4-15, Hiroo, Shibuya-ku, Tokyo 150-0012, Japan

+81 (0)3 6427 5860

inquiry@housserrep-tokyo.com

Transaction Type : Intermediate

Agent Fee : 1 month + tax

Website : www.housserrep-tokyo.com



Remarks
Parking : 1 month deposit / Pet:additional deposit ( 1 month ) / Pet : a small dog or a cat