

Property Name	LA SANTE GOTANDA (GLENPARK G-WEST)	Unit No.	TYPE	Access	Oosakihirokouji Station on Tokyu Ikegami Line (5 min) Gotanda Station on JR Yamanote Line (9 min) Gotanda Station on Toei Asakusa Line (11 min)
	Address	8-9-11, Nishigotanda, Shinagawa-Ku, Tokyo	508		

## High Quality Tower Residence in Gotanda / Shinagawa

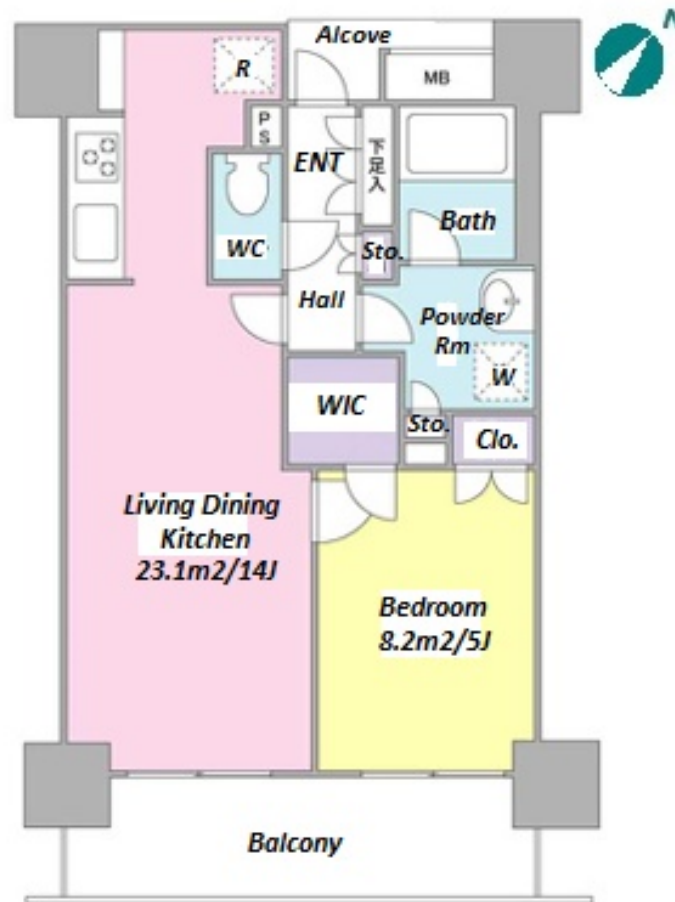

\*The actual Layout & Size may differ slightly from this floor plans & pictures.

Lease Conditions	
LAYOUT	1 BR
SIZE	47.07 m²/506.65 ft²
RENT	JPY 210,000 / month
Management Fee	JPY12,000/month
Deposit	2 months
Key Money	-
Lease Term	Standard lease for 24 months
Available	End, Sep, 2024
Renewal Fee	1 month
Agent Fee	1 month + tax
Other Info	Key Replacement Fee : JPY30,000 Tax not included / No Key Money / Auto lock / Air-Con / Separated Toilet / Balcony / Internet Included / Penalty Fee for Early Cancellation / Musical Instrument Negotiable / CS/CATV / Floor Heating / Bathroom dryer / WIC

Building Information	
Completion	Jan, 2006
Earthquake Resistance	New
Structure	RC, 15 floors above
Car Parking	JPY30,000 + tax / month
Bicycle Parking	for 1 space ( Included )
Music Instrument	Negotiable
Pet	Negotiable
Facilities	Motorcycle Parking (extra charge) / Delivery box

Remarks
Parking : 1 month for deposit



# HOUSEREP TOKYO INC.

ハウスレップトーキョー株式会社

#301, 1-4-15, Hiroo, Shibuya-ku, Tokyo 150-0012, Japan

+81 (0)3 6427 5860

inquiry@housserep-tokyo.com

Transaction Type : Intermediate

Agent Fee : 1 month + tax

Website : www.housserep-tokyo.com

