

Property Name	PARK AXIS SANBANCHO	Unit No.	TYPE	Access	Hannzoumonn Station on Hanzomon Line (6 min) Ichigaya Station on JR Chuo Line Rapid Service (13 min)
		701	Apt.		
Address	3-2, Sambancho, Chiyoda-Ku, Tokyo				

New "Park Axis" series apartment in Hanzomon, Chiyoda.

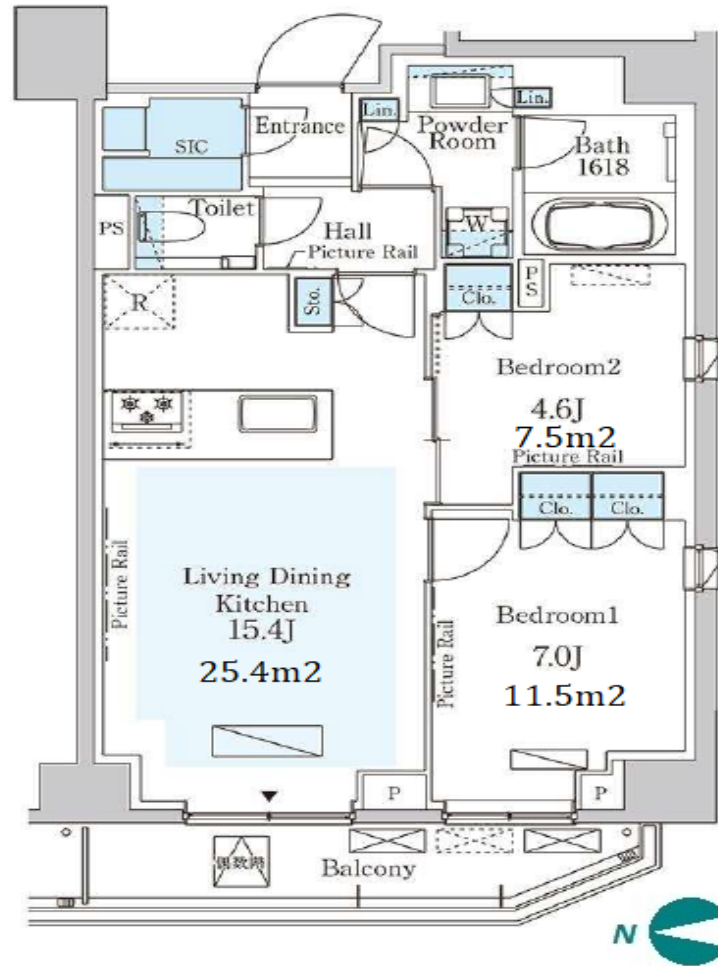

*The actual Layout & Size may differ slightly from this floor plans & pictures.

Lease Conditions	
LAYOUT	2 BR
SIZE	63.04 m ² /678.55 ft ²
RENT	JPY 390,000 / month
Management Fee	JPY20,000/month
Deposit	2 months
Key Money	1 month
Lease Term	Standard lease for 24 months
Available	Now
Renewal Fee	1 month
Agent Fee	1 month + tax
Other Info	Key Replacement Fee : JPY15,000 Tax not included / Guarantor Company : TBC / Free rent / Auto lock / Air-Con / Separated Toilet / Balcony / Flooring / Floor Heating / Dishwasher / Oven / Bathroom dryer / Corner Unit

Building Information	
Completion	Feb, 2021
Earthquake Resistance	New
Structure	RC, 9 floors above
Car Parking	N/A
Bicycle Parking	extra charge
Music Instrument	-
Pet	Allowed
Facilities	Near Large Parks / Elevator / Newly-built (~7 y/o)

Remarks	
Bicycle parking : 2,000yen+tax for a sticker / Pet:additional deposit (1 month) / Pet: Additional 1 month of rent	



HOUSEREP TOKYO INC.
ハウスレップトーキョー株式会社

#301, 1-4-15, Hiroo, Shibuya-ku, Tokyo 150-0012, Japan
+81 (0)3 6427 5860 inquiry@housserrep-tokyo.com

Transaction Type : Intermediate
Agent Fee : 1 month + tax

Website : www.housserrep-tokyo.com

