

Property Name	PARK HABIO SHIBUYA HONMACHI RESIDENCE	Unit No.	TYPE	Access	Nishishinnjukugochoume Station on Oedo Line (7 min) Hatsudai Station on Keio Line (13 min)
		424	Apt.		
Address	4-22-10, Hommachi, Shibuya-Ku, Tokyo				

Stylish apartment in Nishi-shinjuku area

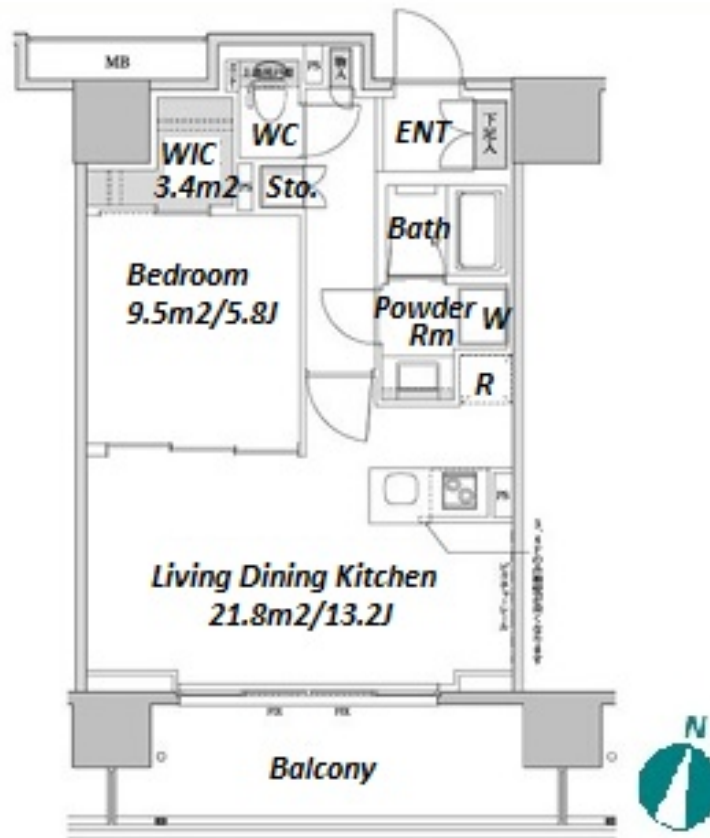

Lease Conditions		
LAYOUT	1 BR	
SIZE	48.5 m²/522.04 ft²	
RENT	JPY 217,000 / month	
Management Fee	JPY10,000/month	
Deposit	2 months	Key Money -
Lease Term	Standard lease for 24 months	
Available	End, Sep, 2024	
Renewal Fee	1 month	
Agent Fee	1 month + tax	
Other Info	Key Replacement Fee : JPY20,000 Tax not included / No Key Money / Auto lock / Air-Con / Separated Toilet / Balcony / Internet (Extra Charge) / Penalty Fee for Early Cancellation / Musical Instrument Negotiable / Flooring / Floor Heating / IH Stoves / Bathroom dryer / WIC	

Building Information		
Completion	Apr, 2011	Earthquake Resistance New
Structure	RC, 13 floors above and 1 basement floors	
Car Parking	N/A	
Bicycle Parking	TBC	
Music Instrument	Negotiable	Pet Negotiable
Facilities	Motorcycle Parking (TBC) / Near Large Parks / Front desk / Delivery box / Elevator / Security / 24h Garbage Drop-off	

Remarks
REAL Premium Membership fee: 15,000yen+tax/2 years

*The actual Layout & Size may differ slightly from this floor plans & pictures.



HOUSEREP TOKYO INC.

ハウスレップトーキョー株式会社

#301, 1-4-15, Hiroo, Shibuya-ku, Tokyo 150-0012, Japan

+81 (0)3 6427 5860

inquiry@housserrep-tokyo.com

Transaction Type : Intermediate

Agent Fee : 1 month + tax

Website : www.housserrep-tokyo.com

