

Property Name	RESIDIA SETAGAYA	Unit No.	TYPE	Access	Komazawadaigaku Station on Denentoshi Line (10 min) Sakurashinmachi Station on Denentoshi Line (11 min)
	TSURUMAKI	503	Apt.		
Address	2-10-9, Tsurumaki, Setagaya-Ku, Tokyo				

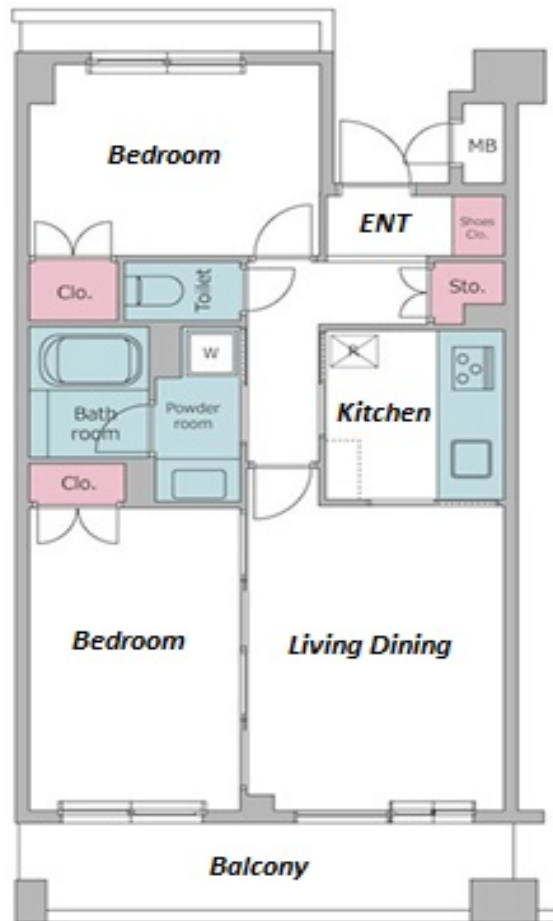

Lease Conditions		
LAYOUT	2 BR	
SIZE	56.07 m ² /603.53 ft ²	
RENT	JPY 238,000 / month	
Management Fee	JPY 15,000/month	
Deposit	2 months	Key Money 1 month
Lease Term	Standard lease for 24 months	
Available	Now	
Renewal Fee	1 month	
Agent Fee	1 month + tax	
Other Info	Key Replacement Fee : JPY 18,000 Tax not included / Guarantor Company : TBC / Auto lock / Renovated / Air-Con / Separated Toilet / Balcony / Internet (Extra Charge) / Penalty Fee for Early Cancellation / Flooring / Bathroom dryer	

Building Information		
Completion	Mar, 2002	Earthquake Resistance New
Structure	RC, 5 floors above	
Car Parking	N/A	
Bicycle Parking	TBC	
Music Instrument	-	Pet N/A
Facilities	Motorcycle Parking (TBC) / Near Large Parks / Janitor / Delivery box / Elevator	

Remarks
Tenant support fee: JPY.10,000+tax/2years Internet usage fee: JPY.1,500+tax/month

*The actual Layout & Size may differ slightly from this floor plans & pictures.



HOUSEREP TOKYO INC.

ハウスレップトーキョー株式会社

#301, 1-4-15, Hiroo, Shibuya-ku, Tokyo 150-0012, Japan

+81 (0)3 6427 5860

inquiry@housserrep-tokyo.com

Transaction Type : Intermediate

Agent Fee : 1 month + tax

Website : www.housserrep-tokyo.com

