

Property Name	PROUD TOWER MEGURO MARC	Unit No.	TYPE	Access	Fudoumae Station on Tokyu Meguro Line (6 min) Meguro Station on JR Yamanote Line (8 min) Gotanda Station on JR Yamanote Line (9 min)
		2504	Apt.		
Address	3-3-2, Higashigotanda, Shinagawa-Ku, Tokyo				

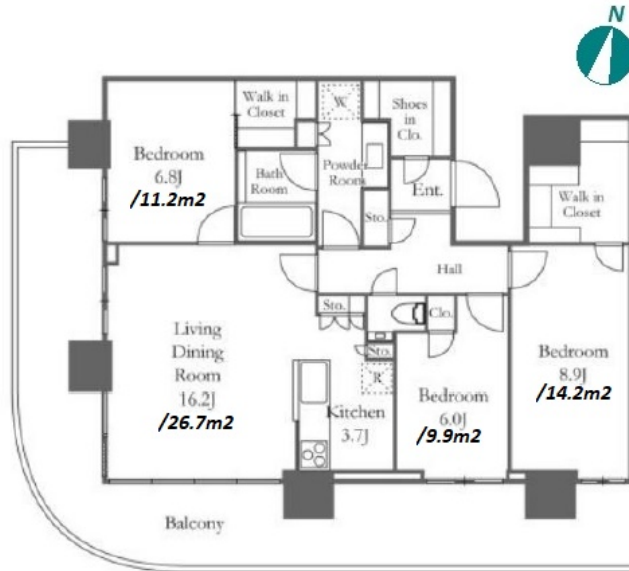

Lease Conditions

LAYOUT	3 BR		
SIZE	101.22 m ² /1089.52 ft ²		
RENT	JPY 770,000 / month		
Management Fee	JPY30,000/month		
Deposit	2 months	Key Money	1 month
Lease Term	Fixed term lease for 36 months		
Available	Now		
Renewal Fee	-		
Agent Fee	1 month + tax		
Other Info	Guarantor Company : TBC / Auto lock / Air-Con / Separated Toilet / Balcony / Flooring / WIC / Corner Unit		

Building Information

Completion	Oct, 2023	Earthquake Resistance	New
Structure	RC, 32 floors above and 1 basement floors		
Car Parking	JPY46,000 + tax / month		
Bicycle Parking	-		
Music Instrument	-	Pet	Negotiable
Facilities	Gym (extra charge) / Delivery box / Elevator / Sky lounge / Security / 24h Garbage Drop-off / Newly-built (~1 y/o)		

Remarks

Renters Insurance : Required

*The actual Layout & Size may differ slightly from this floor plans & pictures.



HOUSEREP TOKYO INC.

ハウスレップトーキョー株式会社

#301, 1-4-15, Hiroo, Shibuya-ku, Tokyo 150-0012, Japan

+81 (0)3 6427 5860

inquiry@housserep-tokyo.com

Transaction Type : Intermediate

Agent Fee : 1 month + tax

Website : www.housserep-tokyo.com

