

Property Name	HIROO GARDEN FOREST KAEDE RESIDENCE C	Unit No.	TYPE	Access	Hiroo Station on Hibiya Line (9 min)
		314	Apt.		
Address	4-1-27, Hiroo, Shibuya-Ku, Tokyo				

Luxury Residence with Greenery on Hilltop, Walkable to Arisugawa Memorial Park

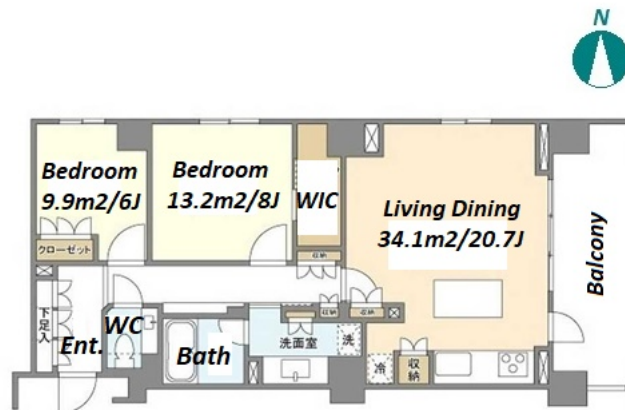

Lease Conditions		
LAYOUT	2 BR	
SIZE	88.27 m²/950.13 ft²	
RENT	JPY 630,000 / month	
Management Fee	-	
Deposit	2 months	Key Money 1 month
Lease Term	Fixed term lease for 36 months	
Available	Now	
Renewal Fee	-	
Agent Fee	1 month + tax	
Other Info	Guarantor Company : TBC / Auto lock / Air-Con / Separated Toilet / Balcony / Penalty Fee for Early Cancellation / No Smoking / Flooring / Floor Heating / Dishwasher / Bathroom dryer / WIC	

Building Information		
Completion	Nov, 2008	Earthquake Resistance New
Structure	RC, 11 floors above and 2 basement floors	
Car Parking	JPY36,000 ~ 38,000/ month	
Bicycle Parking	JPY300/ month	
Music Instrument	-	Pet N/A
Facilities	Motorcycle Parking (JPY3,000/ month) / Within 20 min to Roppongi by train / Within 20 min to Tokyo station by car / Front desk / Concierge / Janitor / Delivery box / Elevator / Security / 24h Garbage Drop-off	

Remarks
Renters Insurance : Required

*The actual Layout & Size may differ slightly from this floor plans & pictures.



HOUSEREP TOKYO INC.

ハウスレップトーキョー株式会社

#301, 1-4-15, Hiroo, Shibuya-ku, Tokyo 150-0012, Japan

+81 (0)3 6427 5860 inquiry@housserrep-tokyo.com

Transaction Type : Intermediate

Agent Fee : 1 month + tax

Website : www.housserrep-tokyo.com

