

Property Name	PARK AXIS IRIYA	Unit No.	TYPE	Access	Iriya Station on Hibiya Line (5 min)
		1305	Apt.		
Address	2-38-4, Iriya, Taito-Ku, Tokyo				

Mid-rise Apt. in Iriya, near ueno

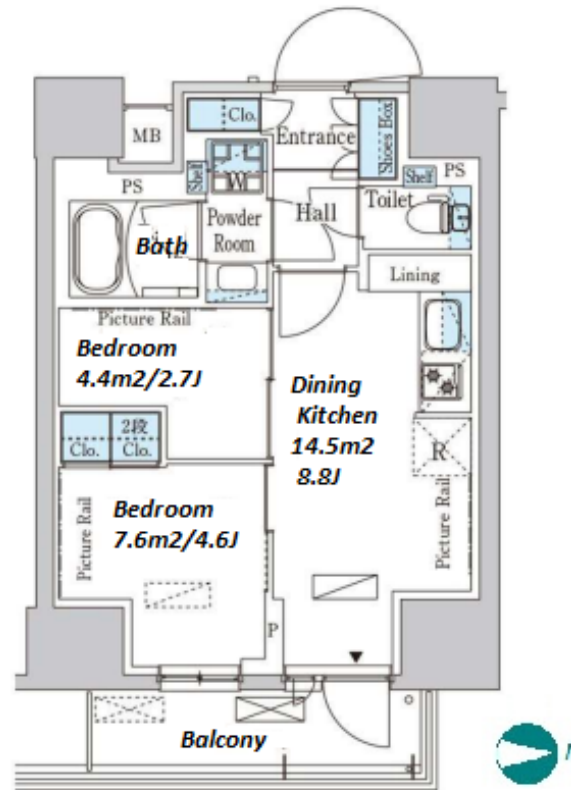

Lease Conditions	
LAYOUT	2 BR
SIZE	39.79 m ² /428.29 ft ²
RENT	JPY 163,000 / month
Management Fee	JPY15,000/month
Deposit	2 months
Key Money	-
Lease Term	Standard lease for 24 months
Available	Early, Oct, 2024
Renewal Fee	1 month
Agent Fee	1 month + tax
Other Info	Key Replacement Fee : JPY25,000 Tax not included / Guarantor Company : TBC / Auto lock / Air-Con / Separated Toilet / Balcony / Penalty Fee for Early Cancellation / Musical Instrument Negotiable / CS/CATV / Flooring / Bathroom dryer

Building Information			
Completion	Mar, 2022	Earthquake Resistance	New
Structure	RC, 14 floors above		
Car Parking	JPY35,000 + tax / month		
Bicycle Parking	for 1 space (Included)		
Music Instrument	Negotiable	Pet	Allowed
Facilities	Motorcycle Parking (JPY3,500 + tax / month) / Janitor / Delivery box / Elevator / Close to Station / Newly-built (~1 y/o)		

Remarks
Renters Insurance : Required / Bicycle parking : Registration fee: JPY2,000+tax / Pet:additional deposit (1 month) / Pet : a small dog or a cat

*The actual Layout & Size may differ slightly from this floor plans & pictures.



HOUSEREP TOKYO INC.

ハウズレップトーキョー株式会社

#301, 1-4-15, Hiroo, Shibuya-ku, Tokyo 150-0012, Japan

+81 (0)3 6427 5860

inquiry@housserrep-tokyo.com

Transaction Type : Intermediate

Agent Fee : 1 month + tax

Website : www.housserrep-tokyo.com

