

|               |   |          |      |        |  |
|---------------|---|----------|------|--------|--|
| Property Name | DUE WASEDA  | Unit No. | TYPE | Access | Nishiwaseda Station on Fukutoshin Line (9 min) |
|               |   | 1103     | Apt. |        |  |
| Address       | 2-6-1, Nishiwaseda(2-chome1-ban1-23-go.2-b, Shinjuku-Ku, Tokyo) |          |      |        |  |

## Modern Mid-rise Apt. in Waseda

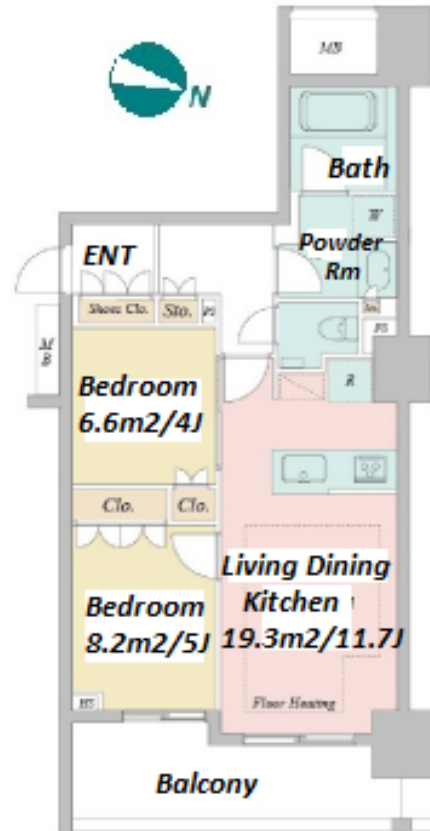

\*The actual Layout & Size may differ slightly from this floor plans & pictures.

| Lease Conditions |  |
|------------------|--|
| LAYOUT           | 2 BR   |
| SIZE             | 51.57 m²/555.09 ft²  |
| RENT             | JPY 260,000 / month  |
| Management Fee   | JPY15,000/month  |
| Deposit          | 2 months   |
| Key Money        | 1 month  |
| Lease Term       | Standard lease for 24 months   |
| Available        | Negotiable   |
| Renewal Fee      | 1 month  |
| Agent Fee        | 1 month + tax  |
| Other Info       | Key Replacement Fee : JPY22,000 Tax not included / Guarantor Company : TBC / Auto lock / Air-Con / Separated Toilet / Balcony / Internet Included / Penalty Fee for Early Cancellation / Flooring / Floor Heating / Bathroom dryer |

| Building Information  |   |
|-----------------------|---|
| Completion            | Aug, 2020   |
| Earthquake Resistance | New   |
| Structure             | RC, 10 floors above and 1 basement floors   |
| Car Parking           | N/A   |
| Bicycle Parking       | JPY300 + tax / month  |
| Music Instrument      | -   |
| Pet                   | Allowed   |
| Facilities            | Gym (( Included )) / Delivery box / Elevator / Fitness / Gym / Newly-built (~7 y/o) |

| Remarks   |
|---|
| Pet:additional deposit ( 1 month ) / Pet : a small dog or a cat |



HOUSEREP TOKYO INC.

ハウスレップトーキョー株式会社

#301, 1-4-15, Hiroo, Shibuya-ku, Tokyo 150-0012, Japan

+81 (0)3 6427 5860

inquiry@housserrep-tokyo.com

Transaction Type : Intermediate

Agent Fee : 1 month + tax

Website : www.housserrep-tokyo.com

