

Property Name	PRIME RESIDENCE SHIBUYA	Unit No.	TYPE	Access	Shibuya Station on JR Yamanote Line (11 min) Ebisu Station on JR Yamanote Line (12 min)
		1002	Apt.		
Address	2-21-8, Higashi, Shibuya-Ku, Tokyo				

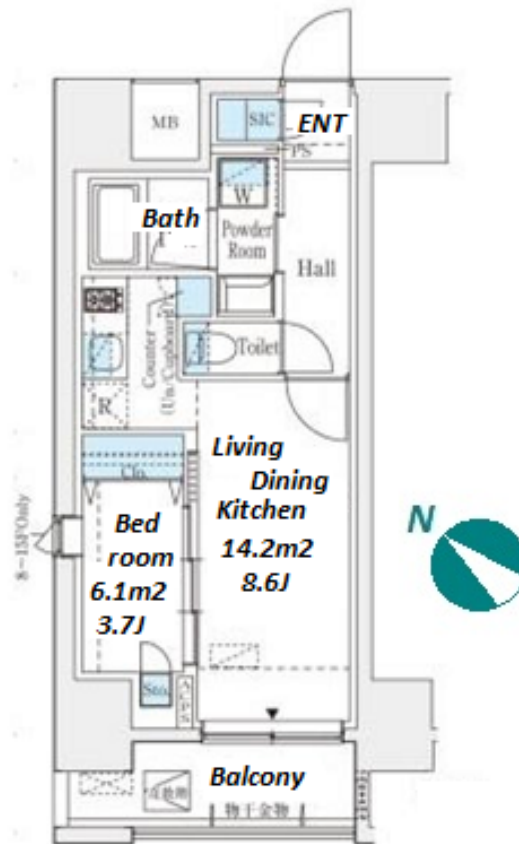

*The actual Layout & Size may differ slightly from this floor plans & pictures.

Lease Conditions			
LAYOUT	1 BR		
SIZE	33.39 m²/359.4 ft²		
RENT	JPY 188,000 / month		
Management Fee	JPY12,000/month		
Deposit	2 months	Key Money	-
Lease Term	Standard lease for 24 months		
Available	End, Aug, 2024		
Renewal Fee	1 month		
Agent Fee	1 month + tax		
Other Info	Key Replacement Fee : JPY20,000 Tax not included / Guarantor Company : TBC / No Key Money / Auto lock / Air-Con / Separated Toilet / Balcony / Penalty Fee for Early Cancellation / Musical Instrument Negotiable / Flooring / Bathroom dryer		
Building Information			
Completion	May, 2017	Earthquake Resistance	New
Structure	RC, 15 floors above		
Car Parking	-		
Bicycle Parking	for 1 space (Included)		
Music Instrument	Negotiable	Pet	-
Facilities	Motorcycle Parking (TBC) / Janitor / Delivery box / Elevator / High-rise / Newly-built (~7 y/o)		

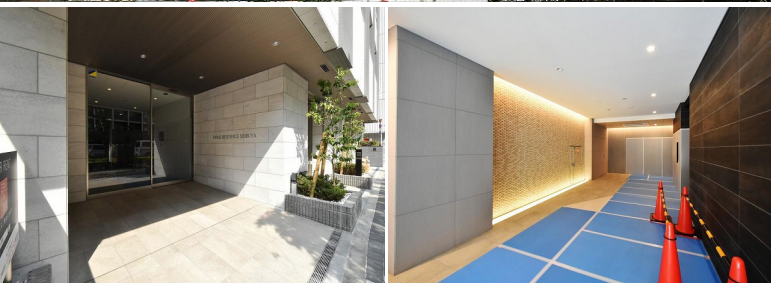

HOUSEREP TOKYO INC.

ハウズレップトーキョー株式会社

#301, 1-4-15, Hiroo, Shibuya-ku, Tokyo 150-0012, Japan

+81 (0)3 6427 5860 inquiry@housserep-tokyo.com

Transaction Type : Intermediate

Agent Fee : 1 month + tax

Website : www.housserep-tokyo.com



Remarks
Renters Insurance : Required