

Property Name	PARK COURT AOYAMA THE TOWER	Unit No.	TYPE	Access	Aoyamaicchoume Station on Ginza Line (3 min) Aoyamaicchoume Station on Hanzomon Line (3 min) Aoyamaicchoume Station on Oedo Line (3 min)
		802	Apt.		
Address	2-3-3, Minamiaoyama, Minato-Ku, Tokyo				

Luxury High Rise Apt.in Aoyama, near "Outer Garden of Meiji Shrine"

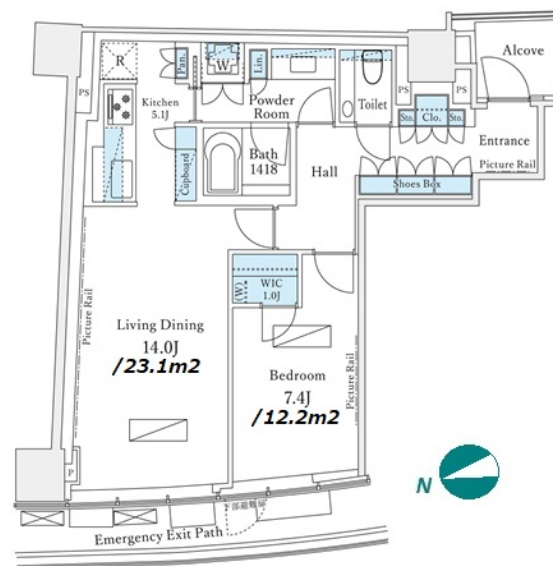
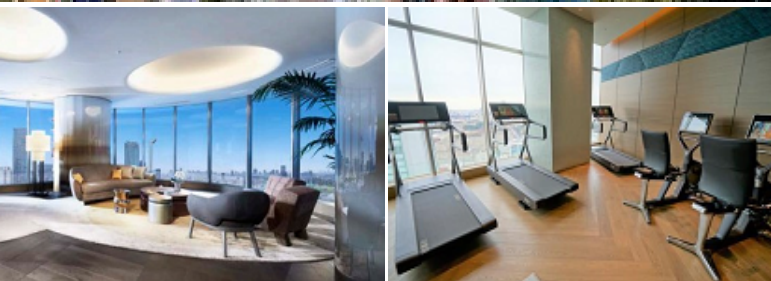
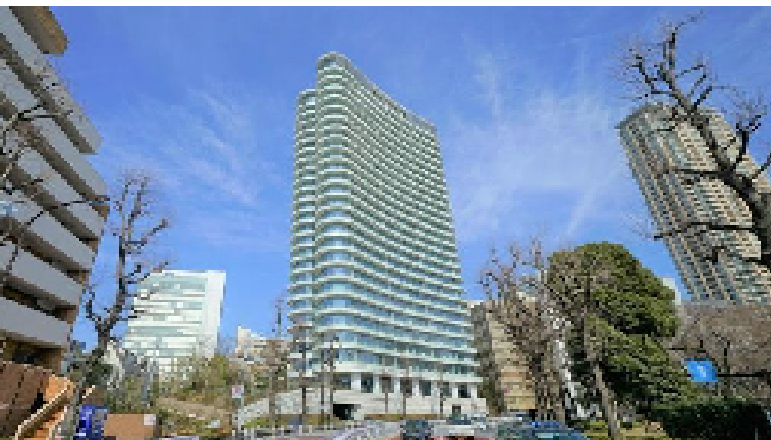

Lease Conditions		
LAYOUT	1 BR	
SIZE	70.07 m ² /754.22 ft ²	
RENT	JPY 650,000 / month	
Management Fee	-	
Deposit	2 months	Key Money 1 month
Lease Term	Standard lease for 24 months	
Available	End, Aug, 2024	
Renewal Fee	1 month	
Agent Fee	1 month + tax	
Other Info	Key Replacement Fee : JPY20,000 Tax not included / Guarantor Company : TBC / Auto lock / Air-Con / Separated Toilet / CS/CATV / Flooring / WIC	

Building Information		
Completion	Apr, 2018	Earthquake Resistance New
Structure	RC, 26 floors above and 1 basement floors	
Car Parking	TBC	
Bicycle Parking	TBC	
Music Instrument	-	Pet -
Facilities	Motorcycle Parking (TBC) / Gym ((Included)) / Within 20 min walk to Roppongi / Within 20 min to Roppongi by train / Near Large Parks / pool / Front desk / Concierge / Janitor / Delivery box / Elevator / Sky lounge / Close to Station / High-rise / Newly-built (~7 y/o)	

Remarks
Renters Insurance : Required

*The actual Layout & Size may differ slightly from this floor plans & pictures.



HOUSEREP TOKYO INC.

ハウスレップトーキョー株式会社

#301, 1-4-15, Hiroo, Shibuya-ku, Tokyo 150-0012, Japan

+81 (0)3 6427 5860

inquiry@housserrep-tokyo.com

Transaction Type : Intermediate

Agent Fee : 1 month + tax

Website : www.housserrep-tokyo.com

