

Property Name	IRIFUNE HEIGHTS	Unit No.	TYPE	Access	Hacchoubori Station on Hibiya Line (4 min) Shinntomichou Station on Yurakucho Line (4 min)
		1406	Apt.		
Address	2-1-1, Irifune, Chuo-Ku, Tokyo				

## Mid-rise Residence in Irifune, near Tsukiji area

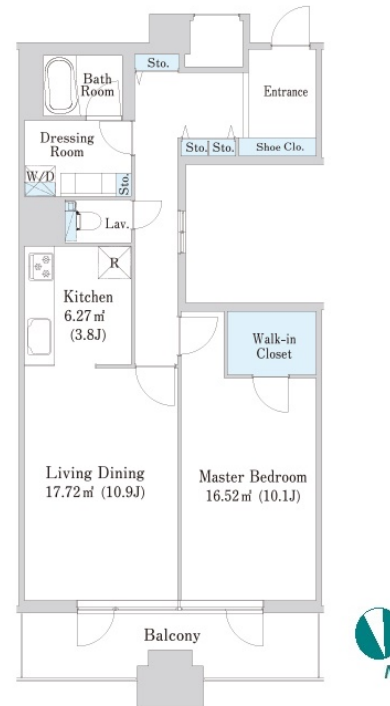

Lease Conditions	
LAYOUT	1 BR
SIZE	66.21 m <sup>2</sup> /712.67 ft <sup>2</sup>
RENT	JPY 298,000 / month
Management Fee	-
Deposit	2 months
Key Money	-
Lease Term	Fixed term lease for 36 months
Available	End, Aug, 2024
Renewal Fee	-
Agent Fee	1 month + tax
Other Info	Depreciation : 1 month / No Key Money / Auto lock / Air-Con / Separated Toilet / Balcony / Internet Included / Penalty Fee for Early Cancellation

Building Information			
Completion	Feb, 1990	Earthquake Resistance	New
Structure	SRC, 14 floors above and 2 basement floors		
Car Parking	extra charge		
Bicycle Parking	extra charge		
Music Instrument	-	Pet	-
Facilities	Trunk Room (extra charge) / Within 20 min to Tokyo station by car / Near Large Parks / Janitor / Delivery box / Elevator / Close to Station		

Remarks
Renters Insurance : Required

\*The actual Layout & Size may differ slightly from this floor plans & pictures.



# HOUSEREP TOKYO INC.

ハウスレップトーキョー株式会社

#301, 1-4-15, Hiroo, Shibuya-ku, Tokyo 150-0012, Japan

+81 (0)3 6427 5860

inquiry@housserrep-tokyo.com

Transaction Type : Intermediate

Agent Fee : 1 month + tax

Website : www.housserrep-tokyo.com

