

Property Name	IB COURT NIHONBASHI	Unit No.	TYPE	Access	Ninngyouchou Station on Hibiya Line (2 min) Ninngyouchou Station on Toei Asakusa Line (2 min)
	NINGYOCHO	903	Apt.		
Address	3-4-8, Nihombashinginyocho, Chuo-Ku, Tokyo				

Mid rise apartment in TOKYO near Ningyocho Sta.

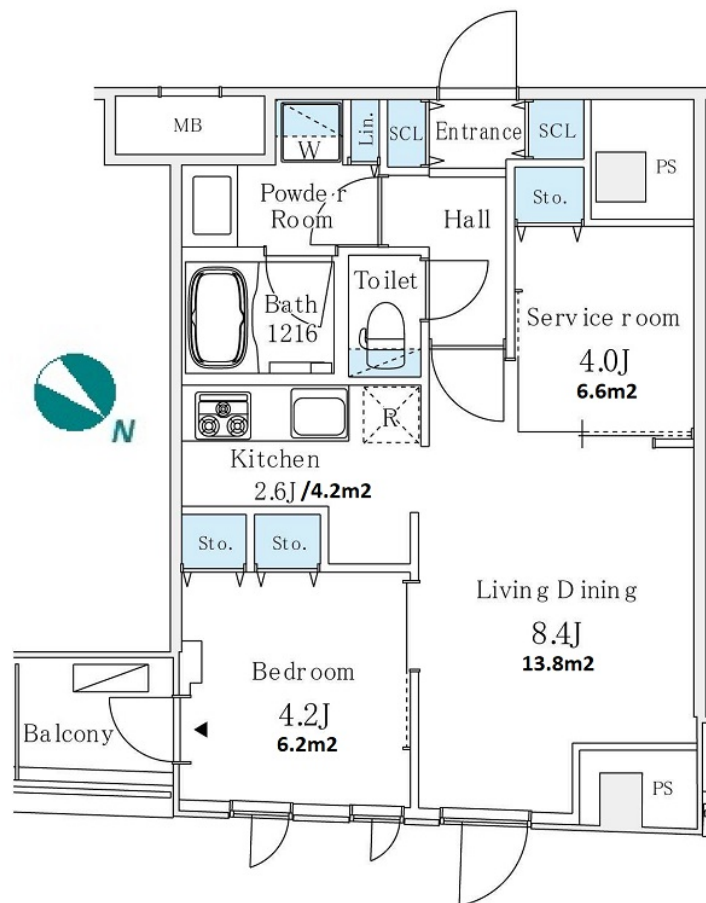

*The actual Layout & Size may differ slightly from this floor plans & pictures.

Lease Conditions		
LAYOUT	2 BR	
SIZE	45.03 m ² /484.69 ft ²	
RENT	JPY 219,000 / month	
Management Fee	JPY20,000/month	
Deposit	0.5 months	Key Money -
Lease Term	Standard lease for 24 months	
Available	Now	
Renewal Fee	1 month	
Agent Fee	1 month + tax	
Other Info	Guarantor Company : TBC / Auto lock / Air-Con / Separated Toilet / Balcony / Internet Included / Penalty Fee for Early Cancellation / Bathroom dryer	

Building Information			
Completion	May, 2024	Earthquake Resistance	New
Structure	RC, 9 floors above		
Car Parking	N/A		
Bicycle Parking	TBC		
Music Instrument	-	Pet	-
Facilities	Janitor / Delivery box / Elevator / Security / Close to Station / Newly-built (~1 y/o)		

Remarks
Renters Insurance : Required



HOUSEREP TOKYO INC.

ハウズレップトーキョー株式会社

#301, 1-4-15, Hiroo, Shibuya-ku, Tokyo 150-0012, Japan

+81 (0)3 6427 5860

inquiry@housserrep-tokyo.com

Transaction Type : Intermediate

Agent Fee : 1 month + tax

Website : www.housserrep-tokyo.com

