

Property Name	PARK AXIS SHIBUYA SAKURAGAOKA	Unit No.	TYPE	Access	Shibuya Station on JR Yamanote Line (6 min) Shibuya Station on Ginza Line (8 min) Shibuya Station on Hanzomon Line (8 min)
		W1204	Apt.		
Address	8-16, Sakuragaokacho, Shibuya-Ku, Tokyo				

Middle Rise Apt. in Shibuya / Daikanyama, Close to "Shibuya Station"

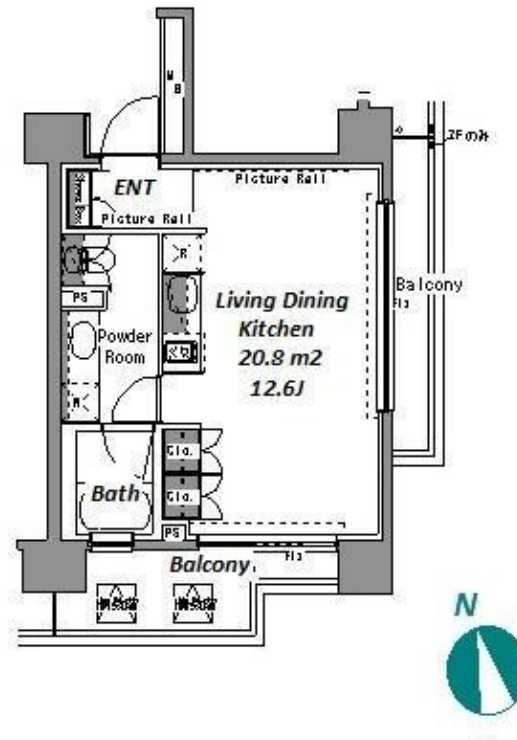

Lease Conditions		
LAYOUT	Studio	
SIZE	31.2 m <sup>2</sup> /335.83 ft <sup>2</sup>	
RENT	JPY 185,000 / month	
Management Fee	JPY8,000/month	
Deposit	2 months	Key Money 1 month
Lease Term	Standard lease for 24 months	
Available	Early, Sep, 2024	
Renewal Fee	1 month	
Agent Fee	1 month + tax	
Other Info	Key Replacement Fee : JPY20,000 Tax not included / Guarantor Company : TBC / Auto lock / Air-Con / Separated Toilet / Balcony / Musical Instrument Negotiable / CS/CATV / Flooring / Washer / Dryer / Bathroom dryer	

Building Information		
Completion	Sep, 2006	Earthquake Resistance New
Structure	RC, 14 floors above	
Car Parking	extra charge	
Bicycle Parking	( Included )	
Music Instrument	Negotiable	Pet Allowed
Facilities	Motorcycle Parking (TBC) / Within 20 min to Roppongi by train / Near Large Parks / Delivery box / Elevator / Security	

Remarks
Renters Insurance : Required / Pet:additional deposit ( 1 month ) / Pet : a small dog or up to two cats

\*The actual Layout & Size may differ slightly from this floor plans & pictures.



HOUSEREP TOKYO INC.

ハウスレップトーキョー株式会社

#301, 1-4-15, Hiroo, Shibuya-ku, Tokyo 150-0012, Japan

+81 (0)3 6427 5860 inquiry@housserrep-tokyo.com

Transaction Type : Intermediate

Agent Fee : 1 month + tax

Website : www.housserrep-tokyo.com

