

Property Name	PARK AXIS MONZENNAKACHO EAST	Unit No.	TYPE	Access	Monzennakachou Station on Oedo Line (5 min) Monzennakachou Station on Tozai Line (5 min) Kiba Station on Tozai Line (5 min)
		203	Apt.		
Address	2-11-20, Tomioka, Koto-Ku, Tokyo				

Mid-rise Apt. in Monzennakacho, easy access to Otemachi / Roppongi / Shinjuku

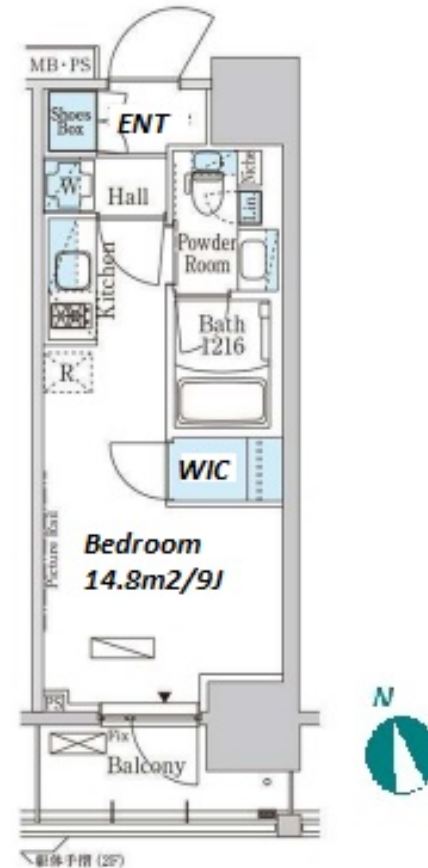

Lease Conditions		
LAYOUT	Studio	
SIZE	25.44 m²/273.83 ft²	
RENT	JPY 110,000 / month	
Management Fee	JPY10,000/month	
Deposit	2 months	Key Money 1 month
Lease Term	Standard lease for 24 months	
Available	Now	
Renewal Fee	1 month	
Agent Fee	1 month + tax	
Other Info	Key Replacement Fee : JPY20,000 Tax not included / Guarantor Company : TBC / Auto lock / Air-Con / Separated Toilet / Balcony / Penalty Fee for Early Cancellation / Musical Instrument Negotiable / CS/CATV / Flooring / Bathroom dryer / WIC	

Building Information		
Completion	Nov, 2020	Earthquake Resistance New
Structure	RC, 13 floors above	
Car Parking	N/A	
Bicycle Parking	for 1 space (Included)	
Music Instrument	Negotiable	Pet Allowed
Facilities	Delivery box / Elevator / Newly-built (~7 y/o)	

*The actual Layout & Size may differ slightly from this floor plans & pictures.



HOUSEREP TOKYO INC.

ハウズレップトーキョー株式会社

#301, 1-4-15, Hiroo, Shibuya-ku, Tokyo 150-0012, Japan

+81 (0)3 6427 5860

inquiry@housserep-tokyo.com

Transaction Type : Intermediate

Agent Fee : 1 month + tax

Website : www.housserep-tokyo.com



Remarks
Renters Insurance : Required / Pet:additional deposit (1 month) / Pet : a small dog or a cat