

Property Name	RIVER CITY 21 SHINKAWA	Unit No.	TYPE	Access	Hacchoubori Station on Hibiya Line (7 min) Tsukishima Station on Yurakucho Line (13 min) Tsukishima Station on Yurakucho Line (13 min)
		809	Apt.		
Address	2-27-4, Shinkawa, Chuo-Ku, Tokyo				

High-rise Apt. in Shinkawa, along Sumida River

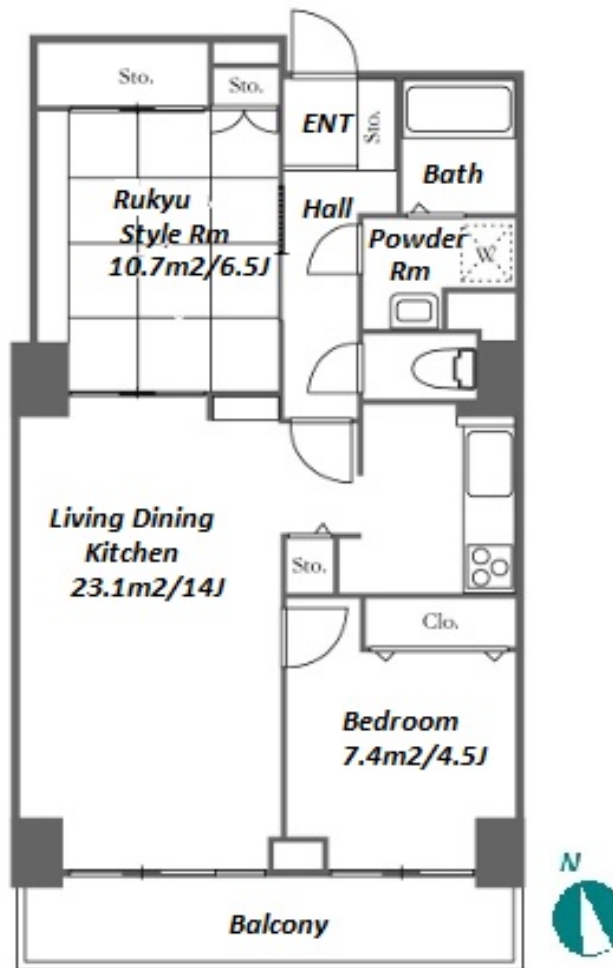
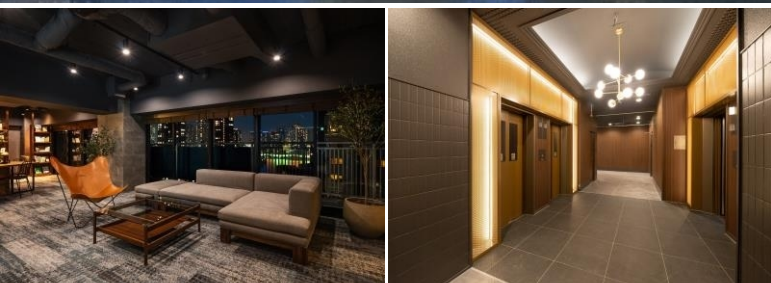

\*The actual Layout & Size may differ slightly from this floor plans & pictures.

Lease Conditions	
LAYOUT	2 BR
SIZE	62.54 m²/673.17 ft²
RENT	JPY 250,000 / month
Management Fee	JPY10,000/month
Deposit	2 months
Key Money	1 month
Lease Term	Fixed term lease for 24 months
Available	Now
Renewal Fee	-
Agent Fee	1 month + tax
Other Info	Key Replacement Fee : JPY15,000 Tax not included / Guarantor Company : TBC / Auto lock / Air-Con / Separated Toilet / Balcony / Nice Views / Flooring / Bathroom dryer / 2 Car Parks

Building Information	
Completion	Jun, 1995
Earthquake Resistance	New
Structure	SRC, 35 floors above and 4 basement floors
Car Parking	JPY35,800 + tax / month
Bicycle Parking	TBC
Music Instrument	-
Pet	N/A
Facilities	Motorcycle Parking (TBC) / Trunk Room (JPY20,000 + tax / month) / Within 20 min to Tokyo station by car / Near Large Parks / Janitor / Delivery box / Elevator / Security / High-rise

Remarks
Renters Insurance : Required / Parking : 3 months deposit



HOUSEREP TOKYO INC.

ハウスレップトーキョー株式会社

#301, 1-4-15, Hiroo, Shibuya-ku, Tokyo 150-0012, Japan

+81 (0)3 6427 5860

inquiry@housserrep-tokyo.com

Transaction Type : Intermediate

Agent Fee : 1 month + tax

Website : www.housserrep-tokyo.com

