

Property Name	NISHIAZABU 223 HOUSE	Unit No.	TYPE	Access	Omotesanndou Station on Ginza Line (10 min) Ropponngi Station on Hibiya Line (13 min)
		-	House		
Address	2-23-20, Nishiazabu, Minato-Ku, Tokyo				

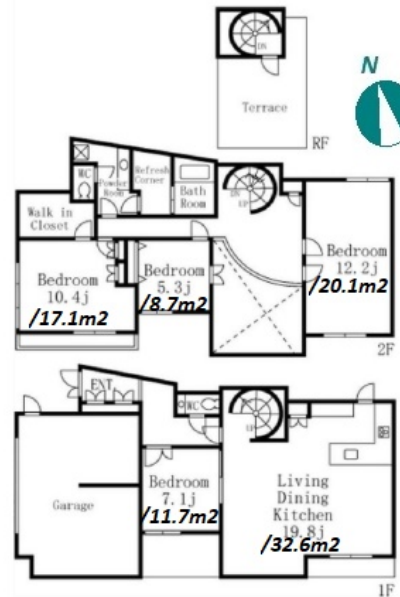

Lease Conditions	
LAYOUT	4 BR
SIZE	165.76 m ² /1784.22 ft ²
RENT	JPY 990,000 / month
Management Fee	-
Deposit	1 month
Key Money	-
Lease Term	Fixed term lease for 60 months
Available	Negotiable
Renewal Fee	-
Agent Fee	1 month + tax
Other Info	Air-Con / Separated Toilet / Balcony / Penalty Fee for Early Cancellation / Roof Balcony / Flooring / Floor Heating / IH Stoves / WIC / 2 Toilets

Building Information			
Completion	Nov, 2000	Earthquake Resistance	New
Structure	Wooden, 2 floors above		
Car Parking	for 1 space (Included)		
Bicycle Parking	-		
Music Instrument	-	Pet	Negotiable
Facilities	House / Within 20 min walk to Roppongi		

Remarks
Renters Insurance : Required / Key replacement fee: required

*The actual Layout & Size may differ slightly from this floor plans & pictures.



HOUSEREP TOKYO INC.

ハウズレップトーキョー株式会社

#301, 1-4-15, Hiroo, Shibuya-ku, Tokyo 150-0012, Japan

+81 (0)3 6427 5860

inquiry@housserrep-tokyo.com

Transaction Type : Intermediate

Agent Fee : 1 month + tax

Website : www.housserrep-tokyo.com

