

|               |                                         |          |      |        |                                                                                                    |
|---------------|-----------------------------------------|----------|------|--------|----------------------------------------------------------------------------------------------------|
| Property Name | FULLHOUSE IIDABASHI                     | Unit No. | TYPE | Access | Iidabashi Station on JR Chuo Line Rapid Service (7 min)<br>Iidabashi Station on Tozai Line (7 min) |
|               |                                         | 103      | Apt. |        |                                                                                                    |
| Address       | 5-9, Shinogawamachi, Shinjuku-Ku, Tokyo |          |      |        |                                                                                                    |

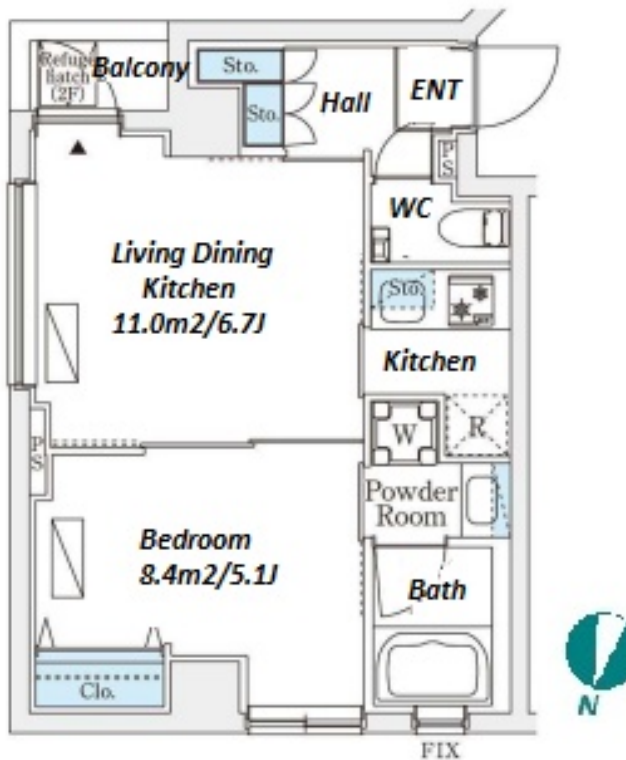

| Lease Conditions |                                                                                                                                                                                |
|------------------|--------------------------------------------------------------------------------------------------------------------------------------------------------------------------------|
| LAYOUT           | 1 BR                                                                                                                                                                           |
| SIZE             | 32.84 m²/353.48 ft²                                                                                                                                                            |
| RENT             | JPY 169,000 / month                                                                                                                                                            |
| Management Fee   | JPY18,000/month                                                                                                                                                                |
| Deposit          | 1 month                                                                                                                                                                        |
| Key Money        | -                                                                                                                                                                              |
| Lease Term       | Standard lease for 24 months                                                                                                                                                   |
| Available        | Negotiable                                                                                                                                                                     |
| Renewal Fee      | 1 month                                                                                                                                                                        |
| Agent Fee        | 1 month + tax                                                                                                                                                                  |
| Other Info       | Guarantor Company : TBC / No Key Money / Auto lock / Air-Con / Separated Toilet / Balcony / Internet Included / Penalty Fee for Early Cancellation / Flooring / Bathroom dryer |

| Building Information |                                                                                                                    |                       |         |
|----------------------|--------------------------------------------------------------------------------------------------------------------|-----------------------|---------|
| Completion           | Feb, 2024                                                                                                          | Earthquake Resistance | New     |
| Structure            | RC, 7 floors above                                                                                                 |                       |         |
| Car Parking          | JPY50,000 ~ 55,000 + tax / month                                                                                   |                       |         |
| Bicycle Parking      | for 1 space ( Included )                                                                                           |                       |         |
| Music Instrument     | -                                                                                                                  | Pet                   | Allowed |
| Facilities           | Concierge / Janitor / Delivery box / Elevator / 24h Garbage Drop-off / Newly-built (~7 y/o) / Newly-built (~1 y/o) |                       |         |

\*The actual Layout & Size may differ slightly from this floor plans & pictures.



HOUSEREP TOKYO INC.

ハウスレップトーキョー株式会社

#301, 1-4-15, Hiroo, Shibuya-ku, Tokyo 150-0012, Japan

+81 (0)3 6427 5860

inquiry@housserrep-tokyo.com

Transaction Type : Intermediate

Agent Fee : 1 month + tax

Website : www.housserrep-tokyo.com



| Remarks                                                                                                 |
|---------------------------------------------------------------------------------------------------------|
| Renters Insurance : Required / Pet:additional deposit ( 1 month ) / Pet : a small dog or up to two cats |