

Property Name	ONE ROOF RESIDENCE	Unit No.	TYPE	Access	Itabashikuyakushomae Station on Mita Line (5 min) Shimoitabashi Station on (10 min)
	ITABASHI OYAMA	1101	Apt.		
Address	29-17, Oyamahigashicho, Itabashi-Ku, Tokyo				

Mid-rise apartment in Itabashi area

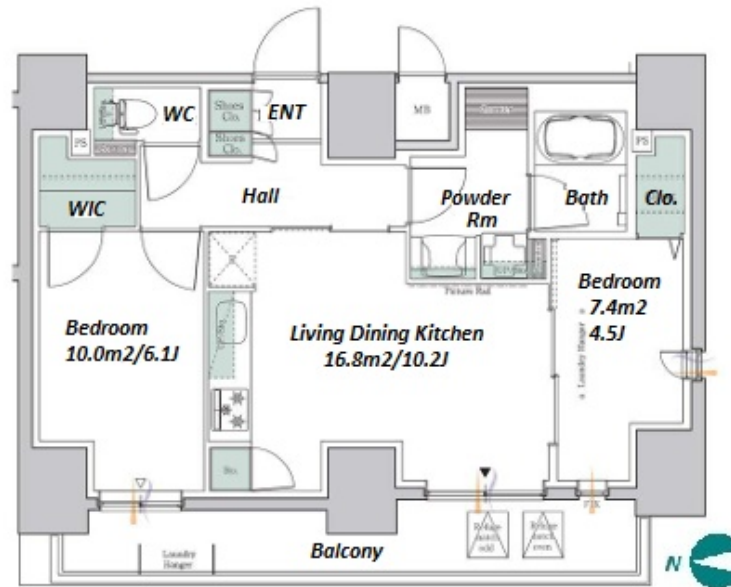

Lease Conditions		
LAYOUT	2 BR	
SIZE	55.62 m ² /598.68 ft ²	
RENT	JPY 229,000 / month	
Management Fee	JPY20,000/month	
Deposit	2 months	Key Money -
Lease Term	Standard lease for 24 months	
Available	Now	
Renewal Fee	1 month	
Agent Fee	1 month + tax	
Other Info	Guarantor Company : TBC / No Key Money / Free rent / Auto lock / Air-Con / Separated Toilet / Balcony / Internet Included / Penalty Fee for Early Cancellation / Flooring / Bathroom dryer / WIC	

Building Information		
Completion	Dec, 2023	Earthquake Resistance New
Structure	RC, 12 floors above	
Car Parking	N/A	
Bicycle Parking	TBC	
Music Instrument	-	Pet Negotiable
Facilities	Motorcycle Parking (TBC) / Delivery box / Elevator / Security / Close to Station / Newly-built (~7 y/o)	

Remarks
Renters Insurance : Required

*The actual Layout & Size may differ slightly from this floor plans & pictures.



HOUSEREP TOKYO INC.

ハウスレップトーキョー株式会社

#301, 1-4-15, Hiroo, Shibuya-ku, Tokyo 150-0012, Japan

+81 (0)3 6427 5860

inquiry@housserrep-tokyo.com

Transaction Type : Intermediate

Agent Fee : 1 month + tax

Website : www.housserrep-tokyo.com

