

Property Name	URBANEX GINZA HIGASHI II	Unit No.	TYPE	Access	Hacchoubori Station on JR Keiyo Line (5 min) Hacchoubori Station on Hibiya Line (5 min) Shinntomichou Station on Yurakucho Line (10 min)
		603	Apt.		
Address	1-12-3, Minato, Chuo-Ku, Tokyo				

## Mid-rise Apt. in Hatchobori, near Ginza

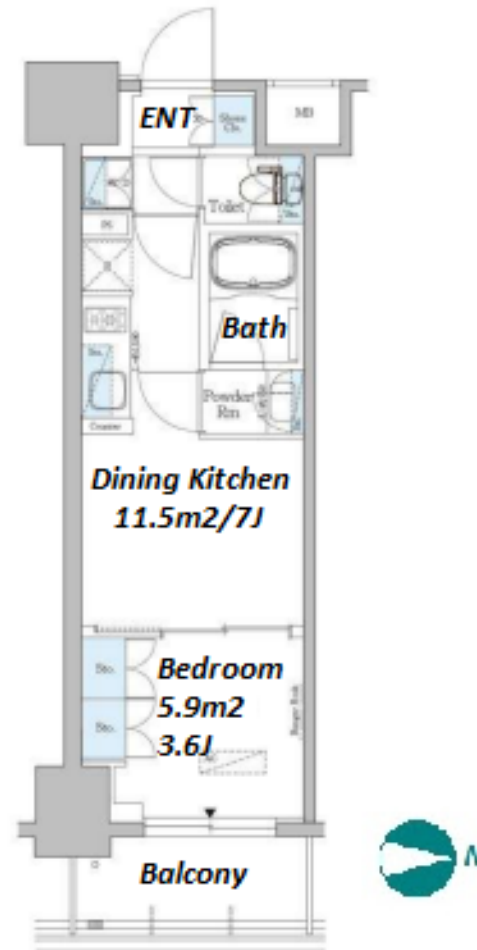

\*The actual Layout & Size may differ slightly from this floor plans & pictures.

Lease Conditions	
LAYOUT	1 BR
SIZE	26.43 m <sup>2</sup> /284.49 ft <sup>2</sup>
RENT	JPY 138,000 / month
Management Fee	JPY12,000/month
Deposit	2 months
Key Money	-
Lease Term	Standard lease for 24 months
Available	End, Jul, 2024
Renewal Fee	1 month
Agent Fee	1 month + tax
Other Info	Key Replacement Fee : JPY20,000 Tax not included / Guarantor Company : TBC / No Key Money / Auto lock / Air-Con / Separated Toilet / Balcony / Penalty Fee for Early Cancellation / Flooring / Bathroom dryer

Building Information			
Completion	Feb, 2019	Earthquake Resistance	New
Structure	RC, 10 floors above		
Car Parking	-		
Bicycle Parking	for 1 space JPY500 + tax / month		
Music Instrument	-	Pet	-
Facilities	Delivery box / Elevator / Newly-built (~7 y/o)		

Remarks
Renters Insurance : Required



HOUSEREP TOKYO INC.

ハウスレップトーキョー株式会社

#301, 1-4-15, Hiroo, Shibuya-ku, Tokyo 150-0012, Japan

+81 (0)3 6427 5860

inquiry@housserep-tokyo.com

Transaction Type : Intermediate

Agent Fee : 1 month + tax

Website : www.housserep-tokyo.com

