

Property Name	KAWADACHO GARDEN	Unit No.	TYPE	Access	Akebonobashi Station on Toei Shinjuku Line (4 min) Wakamatsukawada Station on Oedo Line (6 min) Yotsuyasannchoume Station on Marunouchi Line (15 min)
		1405	Apt.		
Address	3-51, Kawadacho, Shinjuku-Ku, Tokyo				

## Stylish High Rise Apartment in Kawadacho, Shinjuku

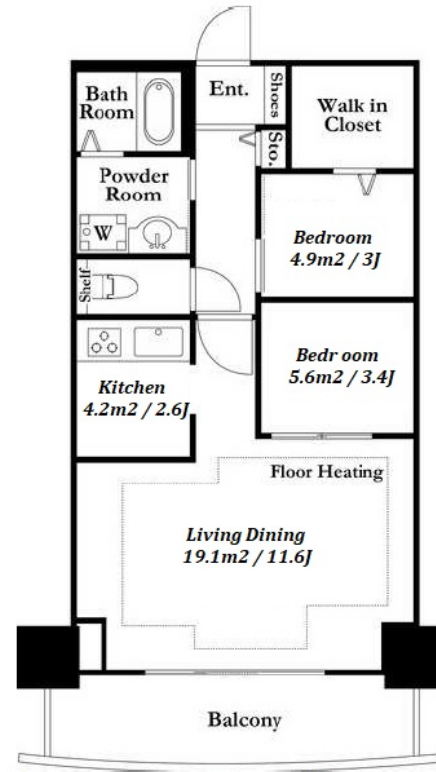

Lease Conditions	
LAYOUT	2 BR
SIZE	52.12 m <sup>2</sup> /561.01 ft <sup>2</sup>
RENT	JPY 238,100 / month
Management Fee	JPY10,000/month
Deposit	-
Key Money	-
Lease Term	Standard lease for 24 months
Available	Mid, Jun, 2024
Renewal Fee	1 month
Agent Fee	1 month + tax
Other Info	Key Replacement Fee : JPY20,000 Tax not included / No Key Money / Auto lock / Air-Con / Separated Toilet / Balcony / Internet (Extra Charge) / Penalty Fee for Early Cancellation / Nice Views / Flooring / Floor Heating / Bathroom dryer / WIC

Building Information			
Completion	Mar, 2003	Earthquake Resistance	New
Structure	RC, 41 floors above and 2 basement floors		
Car Parking	JPY41,580 ~ 50,820 + tax / month		
Bicycle Parking	TBC		
Music Instrument	-	Pet	-
Facilities	Motorcycle Parking (JPY5,000 + tax / month) / Gym (extra charge) / Near Large Parks / Janitor / Delivery box / Elevator / High-rise		

Remarks
Renters Insurance : Required

\*The actual Layout & Size may differ slightly from this floor plans & pictures.



### HOUSEREP TOKYO INC.

ハウスレップトーキョー株式会社

#301, 1-4-15, Hiroo, Shibuya-ku, Tokyo 150-0012, Japan

+81 (0)3 6427 5860

inquiry@housserep-tokyo.com

Transaction Type : Intermediate

Agent Fee : 1 month + tax

Website : www.housserep-tokyo.com

