

Property Name	ROYAL PARKS TOWER	Unit No.	TYPE	Access	Minamisennju Station on JR Joban Line (5 min) Minamisennju Station on Hibiya Line (5 min) Sennjuohashi Station on Keisei Main Line (19 min)
	MINAMISENJU	2104	Apt.		
Address	4-7-3, Minamisennju, Arakawa-Ku, Tokyo				

High Rise Tower Residence in Minamisennju

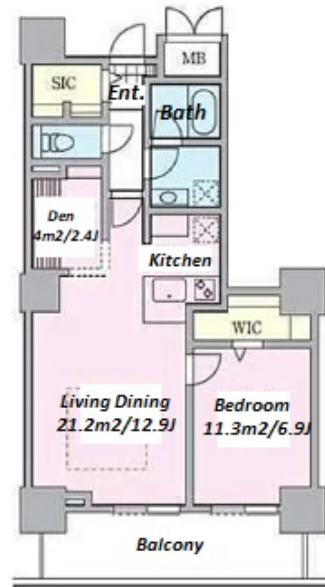

Lease Conditions		
LAYOUT	1 BR+Den	
SIZE	56.8 m²/611.39 ft²	
RENT	JPY 210,000 / month	
Management Fee	JPY 14,000/month	
Deposit	1 month	Key Money 1 month
Lease Term	Fixed term lease for 36 months	
Available	06, Jul, 2024	
Renewal Fee	-	
Agent Fee	1 month + tax	
Other Info	Guarantor Company : TBC / Auto lock / Air-Con / Separated Toilet / Balcony / Internet (Extra Charge) / Floor Heating / Bathroom dryer / WIC	

Building Information		
Completion	May, 2008	Earthquake Resistance New
Structure	RC, 39 floors above and 1 basement floors	
Car Parking	JPY 19,950 + tax / month	
Bicycle Parking	N/A	
Music Instrument	-	Pet Negotiable
Facilities	Motorcycle Parking (TBC) / Front desk / Delivery box	

Remarks
Renters Insurance : Required

*The actual Layout & Size may differ slightly from this floor plans & pictures.



HOUSEREP TOKYO INC.

ハウスレップトーキョー株式会社

#301, 1-4-15, Hiroo, Shibuya-ku, Tokyo 150-0012, Japan

+81 (0)3 6427 5860

inquiry@housserrep-tokyo.com

Transaction Type : Intermediate

Agent Fee : 1 month + tax

Website : www.housserrep-tokyo.com

