

Property Name	I BUILDING	Unit No.	TYPE	Access	Yuutennji Station on Toyoko Line (1 min)
		2F	Apt.		
Address	1-30-10, Gohongi, Meguro-Ku, Tokyo				

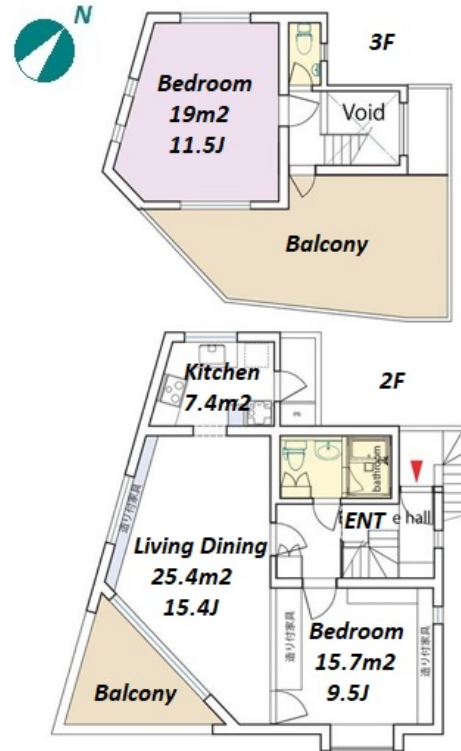
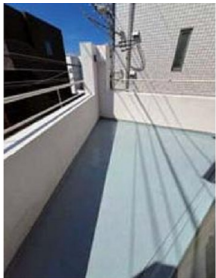

Lease Conditions			
LAYOUT	2 BR		
SIZE	89.5 m ² /963.36 ft ²		
RENT	JPY 354,000 / month		
Management Fee	-		
Deposit	2 months	Key Money	1 month
Lease Term	Standard lease for 24 months		
Available	Now		
Renewal Fee	1 month		
Agent Fee	1 month + tax		
Other Info	Air-Con / Balcony / Loft/Maisonnette / Internet (Extra Charge) / Penalty Fee for Early Cancellation / No Smoking / 2 Toilets		

Building Information			
Completion	Jan, 1983	Earthquake Resistance	New
Structure	RC, 3 floors above and 1 basement floors		
Car Parking	JPY20,000 + tax / month		
Bicycle Parking	JPY1,000/ month		
Music Instrument	-	Pet	
Facilities	Motorcycle Parking (JPY2,000/ month) / Close to Station / Low-rise		

Remarks
Renters Insurance : Required / Pet:additional deposit (1 month) / Pet : 2 months depreciation

*The actual Layout & Size may differ slightly from this floor plans & pictures.



HOUSEREP TOKYO INC.

ハウズレップトーキョー株式会社

#301, 1-4-15, Hiroo, Shibuya-ku, Tokyo 150-0012, Japan

+81 (0)3 6427 5860

inquiry@housserrep-tokyo.com

Transaction Type : Intermediate

Agent Fee : 1 month + tax

Website : www.housserrep-tokyo.com

