

Property Name	INTEGRALE SHIMOUMA	Unit No.	TYPE	Access	Gakugeidaigaku Station on Toyoko Line (6 min)
		A	House		
Address	6-12-18, Shimoma, Setagaya-Ku, Tokyo				

Cozy House in Gakugeidaigaku, near "Park" & "Shopping Mall"

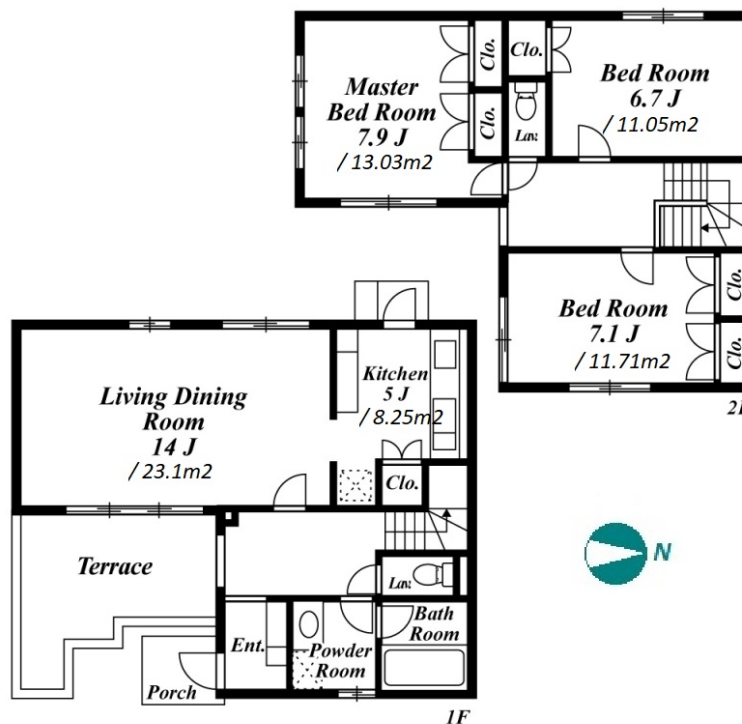

Lease Conditions	
LAYOUT	3 BR
SIZE	104.13 m ² /1120.84 ft ²
RENT	JPY 380,000 / month
Management Fee	-
Deposit	2 months
Key Money	1 month
Lease Term	Standard lease for 24 months
Available	Early, Aug, 2024
Renewal Fee	1 month
Agent Fee	1 month + tax
Other Info	Guarantor Company : TBC / Renovated / Air-Con / Separated Toilet / Balcony / Loft/Maisonnette / Musical Instrument Negotiable / Garden/Terrace / Flooring / 2 Toilets

Building Information	
Completion	Mar, 1995
Earthquake Resistance	New
Structure	Wooden, 2 floors above
Car Parking	for 1 space (Included)
Bicycle Parking	TBC
Music Instrument	Negotiable
Pet	Negotiable
Facilities	Motorcycle Parking (TBC) / Near Large Parks

Remarks
Renters Insurance : Required / *Renovated in Nov.2016 *Wood Deck Terrace

*The actual Layout & Size may differ slightly from this floor plans & pictures.



HOUSEREP TOKYO INC.

ハウスレップトーキョー株式会社

#301, 1-4-15, Hiroo, Shibuya-ku, Tokyo 150-0012, Japan

+81 (0)3 6427 5860

inquiry@housserrep-tokyo.com

Transaction Type : Intermediate

Agent Fee : 1 month + tax

Website : www.housserrep-tokyo.com

