

Property Name	RESIDIA KOENJI	Unit No.	TYPE	Access	Shinnkouennji Station on Marunouchi Line (8 min) Kouennji Station on JR Chuo Line Rapid Service (10 min) Kouennji Station on JR Chuo-Sobu Line (10 min)
		704	Apt.		
Address	5-7-5, Koenjiminami, Suginami-Ku, Tokyo				

Hotel-like Common Area, 2 Sta. 3 Lines Available, Direct to the Central Tokyo

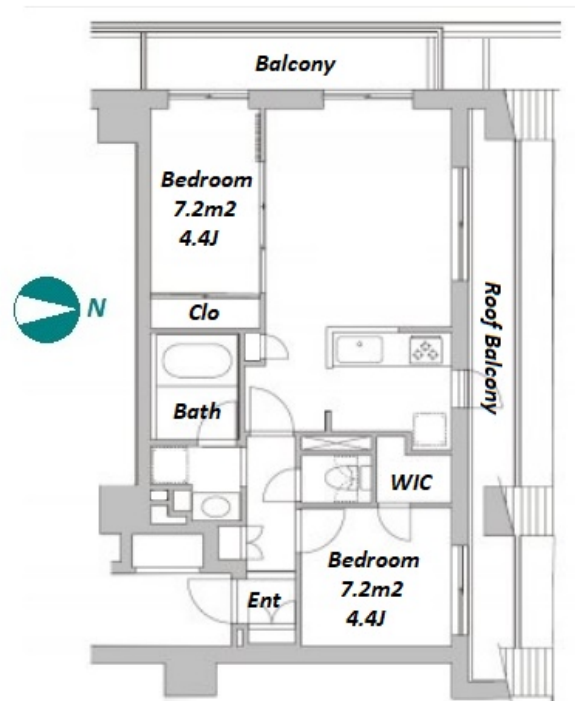

*The actual Layout & Size may differ slightly from this floor plans & pictures.

Lease Conditions	
LAYOUT	2 BR
SIZE	50.5 m²/543.57 ft²
RENT	JPY 215,000 / month
Management Fee	JPY15,000/month
Deposit	2 months
Key Money	1 month
Lease Term	Standard lease for 24 months
Available	Now
Renewal Fee	1 month
Agent Fee	1 month + tax
Other Info	Key Replacement Fee : JPY25,000 Tax not included / Auto lock / Air-Con / Separated Toilet / Balcony / Internet (Extra Charge) / Penalty Fee for Early Cancellation / Roof Balcony / Bathroom dryer

Building Information	
Completion	Mar, 2015
Earthquake Resistance	New
Structure	RC, 8 floors above
Car Parking	JPY33,000 + tax / month
Bicycle Parking	extra charge
Music Instrument	-
Pet	N/A
Facilities	Motorcycle Parking (JPY3,000 + tax / month) / Delivery box / Elevator / 24h Garbage Drop-off

Remarks
Renters Insurance : Required / Parking : Full (1mo. deposit) / Resident Service Fee: JPY10,000+tax/2 years / Internet Fee: JPY1,500+tax/mo.



HOUSEREP TOKYO INC.

ハウズレップトーキョー株式会社

#301, 1-4-15, Hiroo, Shibuya-ku, Tokyo 150-0012, Japan

+81 (0)3 6427 5860

inquiry@housserrep-tokyo.com

Transaction Type : Intermediate

Agent Fee : 1 month + tax

Website : www.housserrep-tokyo.com

