

Property Name	PARK TOWER KACHIDOMI MID	Unit No.	TYPE	Access	Kachidoki Station on Oedo Line (1 min)
		1228	Apt.		
Address	4-6-2, Kachidoki, Chuo-Ku, Tokyo				

## Newly Built High-Rise Apartment, Directly Connected to Kachidoki Station

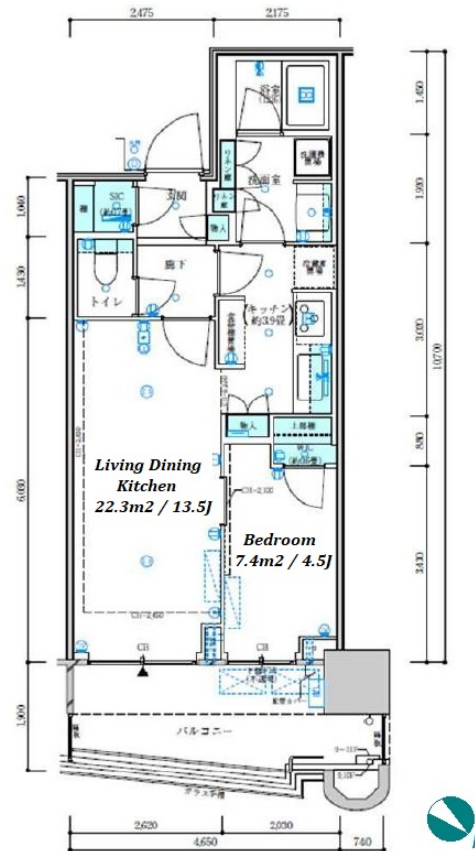

Lease Conditions	
LAYOUT	1 BR
SIZE	44.31 m²/476.94 ft²
RENT	JPY 249,000 / month
Management Fee	-
Deposit	1 month
Key Money	2 months
Lease Term	Standard lease for 24 months
Available	End, Jun, 2024
Renewal Fee	1 month
Agent Fee	1 month + tax
Other Info	Key Replacement Fee : JPY20,000 Tax not included / Auto lock / Air-Con / Separated Toilet / Balcony / Flooring / Bathroom dryer

Building Information	
Completion	Aug, 2023
Earthquake Resistance	New
Structure	RC + S, 45 floors above and 2 basement floors
Car Parking	extra charge
Bicycle Parking	extra charge
Music Instrument	-
Pet	-
Facilities	Janitor / Delivery box / Elevator / Sky lounge / Security / Close to Station / 24h Garbage Drop-off / Fitness / Gym / High-rise / Newly-built (~1 y/o)

\*The actual Layout & Size may differ slightly from this floor plans & pictures.



# HOUSEREP TOKYO INC.

ハウスレップトーキョー株式会社

#301, 1-4-15, Hiroo, Shibuya-ku, Tokyo 150-0012, Japan

+81 (0)3 6427 5860

inquiry@housserrep-tokyo.com

Transaction Type : Intermediate

Agent Fee : 1 month + tax

Website : www.housserrep-tokyo.com



Remarks
Renters Insurance : Required