

Property Name	BELLE VUE CHIYODA IIDABASHI	Unit No.	TYPE	Access	Iidabashi Station on Tozai Line (4 min) Iidabashi Station on JR Chuo-Sobu Line (6 min)
		604	Apt.		
Address	1-12-4, Iidabashi, Chiyoda-Ku, Tokyo				

## New Middle Rise Apt. in Iidabashi

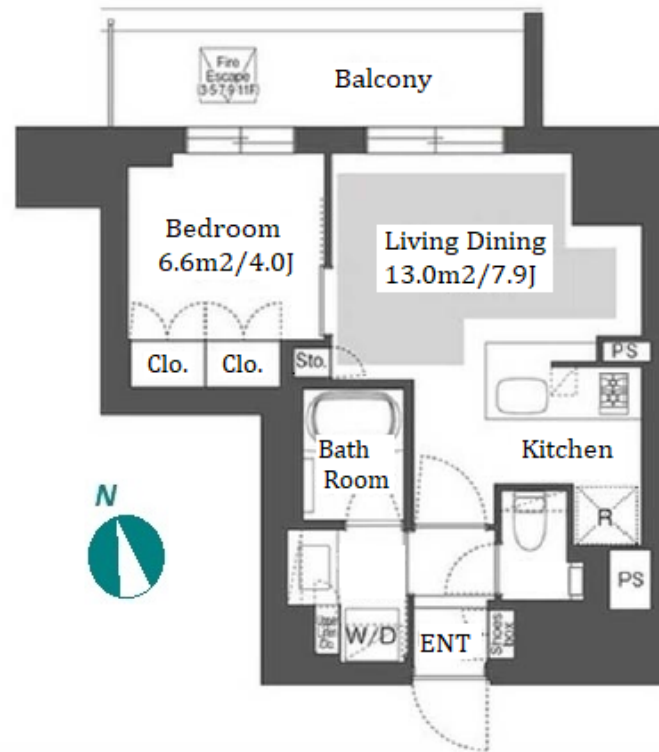

Lease Conditions	
LAYOUT	1 BR
SIZE	36.72 m²/395.25 ft²
RENT	JPY 215,000 / month
Management Fee	JPY 10,000/month
Deposit	2 months
Key Money	1 month
Lease Term	Standard lease for 24 months
Available	Now
Renewal Fee	1 month
Agent Fee	1 month + tax
Other Info	Key Replacement Fee : JPY50,000 Tax not included / Guarantor Company : TBC / Auto lock / Air-Con / Separated Toilet / Balcony / Internet Included / Musical Instrument Negotiable / Flooring / Floor Heating / Dishwasher / Bathroom dryer / Corner Unit

Building Information	
Completion	Jul, 2021
Earthquake Resistance	New
Structure	RC, 12 floors above
Car Parking	-
Bicycle Parking	extra charge
Music Instrument	Negotiable
Pet	N/A
Facilities	Motorcycle Parking (extra charge) / Trunk Room (extra charge) / Within 20 min to Tokyo station by car / Janitor / Delivery box / Elevator / Security / Close to Station / Newly-built (~7 y/o)

\*The actual Layout & Size may differ slightly from this floor plans & pictures.



HOUSEREP TOKYO INC.

ハウスレップトーキョー株式会社

#301, 1-4-15, Hiroo, Shibuya-ku, Tokyo 150-0012, Japan

+81 (0)3 6427 5860 inquiry@housserrep-tokyo.com

Transaction Type : Intermediate

Agent Fee : 1 month + tax

Website : www.housserrep-tokyo.com



Remarks
Renters Insurance : Required