

Property Name	PARK AXIS OCHANOMIZU STAGE	Unit No.	TYPE	Access	Suehirochou Station on Ginza Line (6 min) Yushima Station on Chiyoda Line (6 min) Ochanomizu Station on JR Chuo Line Rapid Service (8 min) Akihabara Station on JR Yamanote Line (13 min)
		704	Apt.		
Address	3-2-14, Yushima, Bunkyo-Ku, Tokyo				

Lease Conditions			
LAYOUT	1 BR		
SIZE	44.57 m ² /479.74 ft ²		
RENT	JPY 200,000 / month		
Management Fee	JPY10,000/month		
Deposit	2 months	Key Money	1 month
Lease Term	Standard lease for 24 months		
Available	End, Jun, 2024		
Renewal Fee	1 month		
Agent Fee	1 month + tax		
Other Info	Key Replacement Fee : JPY15,000 Tax not included / Guarantor Company : TBC / Auto lock / Air-Con / Separated Toilet / Balcony / Penalty Fee for Early Cancellation / Musical Instrument Negotiable / CS/CATV / Floor Heating / Bathroom dryer		

Building Information			
Completion	Feb, 2006	Earthquake Resistance	New
Structure	RC, 14 floors above		
Car Parking	extra charge		
Bicycle Parking	for 1 space (Included)		
Music Instrument	Negotiable	Pet	Allowed
Facilities	Motorcycle Parking (TBC) / Within 20 min to Tokyo station by car / Janitor / Delivery box / Elevator / Security		

Remarks

Mid-rise Apt. in Ochanomizu, near Akihabara



Renters Insurance : Required / Bicycle parking : Registration fee:
JPY.2,000+tax / Pet:additional deposit (1 month) / Pet : up to two small
dogs/ No cat

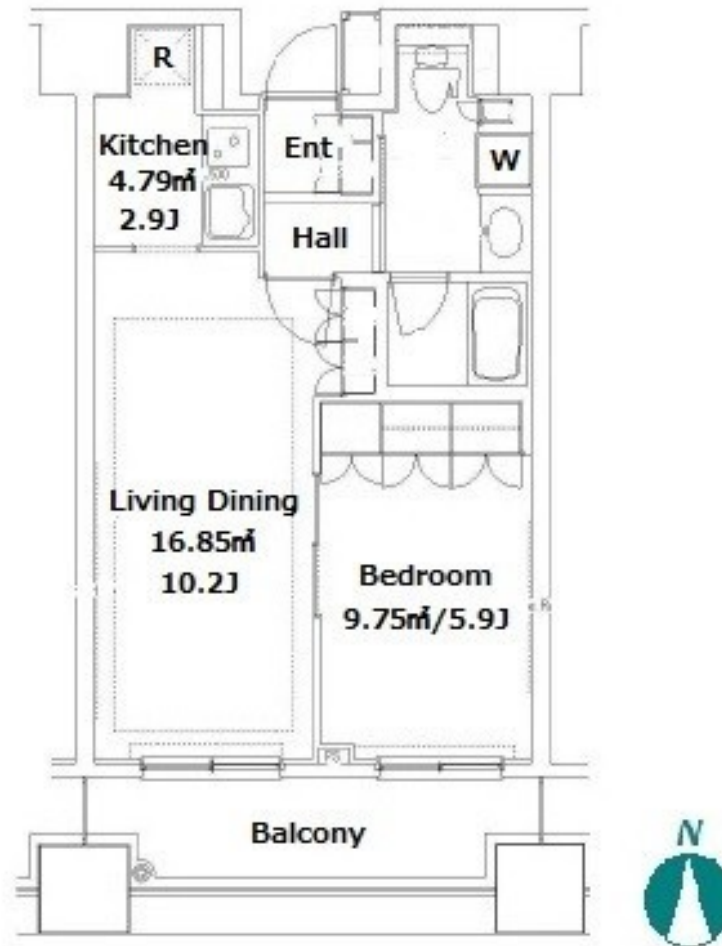

*The actual Layout & Size may differ slightly from this floor plans & pictures.



HOUSEREP TOKYO INC.

ハウスレップトーキョー株式会社

#301, 1-4-15, Hiroo, Shibuya-ku, Tokyo 150-0012, Japan

+81 (0)3 6427 5860 inquiry@houserep-tokyo.com

Transaction Type : Intermediate

Agent Fee : 1 month + tax

Website : www.houserep-tokyo.com

