

Property Name	BRANCHE HIGASHIAZABU	Unit No.	TYPE	Access	Akabanebashi Station on Oedo Line (3 min) Azabujuban Station on Namboku Line (9 min) Azabujuban Station on Oedo Line (9 min)
		501	Apt.		
Address	1-15-2, Higashiazabu, Minato-Ku, Tokyo				

## Stylish Apt. in Higashi-Azabu near Tokyo Tower

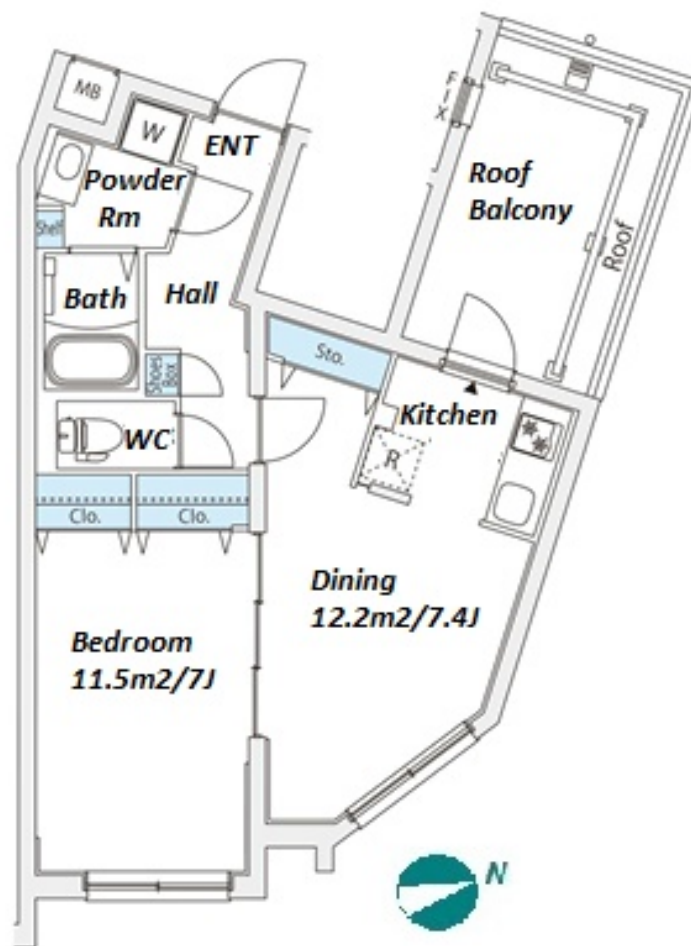

\*The actual Layout & Size may differ slightly from this floor plans & pictures.

Lease Conditions	
LAYOUT	1 BR
SIZE	41.84 m²/450.36 ft²
RENT	JPY 188,000 / month
Management Fee	JPY10,000/month
Deposit	2 months
Key Money	1 month
Lease Term	Standard lease for 24 months
Available	Negotiable
Renewal Fee	1 month
Agent Fee	1 month + tax
Other Info	Key Replacement Fee : JPY20,000 Tax not included / Guarantor Company : TBC / Auto lock / Air-Con / Separated Toilet / Internet Included / Penalty Fee for Early Cancellation / No Smoking / Roof Balcony / Flooring / Bathroom dryer

Building Information			
Completion	Mar, 2019	Earthquake Resistance	New
Structure	RC, 5 floors above		
Car Parking	N/A		
Bicycle Parking	N/A		
Music Instrument	-	Pet	-
Facilities	Near Large Parks / Janitor / Delivery box / Close to Station / Low-rise / Newly-built (~7 y/o)		

Remarks
Renters Insurance : Required



HOUSEREP TOKYO INC.

ハウスレップトーキョー株式会社

#301, 1-4-15, Hiroo, Shibuya-ku, Tokyo 150-0012, Japan

+81 (0)3 6427 5860

inquiry@housserrep-tokyo.com

Transaction Type : Intermediate

Agent Fee : 1 month + tax

Website : www.housserrep-tokyo.com

