

Property Name	RERENT SHIRAYURI	Unit No.	TYPE	Access	Yoyogihachimann Station on Odakyu Line (5 min) Yoyogikouenn Station on Chiyoda Line (6 min) Yoyogiuehara Station on Odakyu Line (7 min)
		301	Apt.		
Address	23-12, Motoyoyogicho, Shibuya-Ku, Tokyo				

## Low-rise apartment near Yoyogi Park

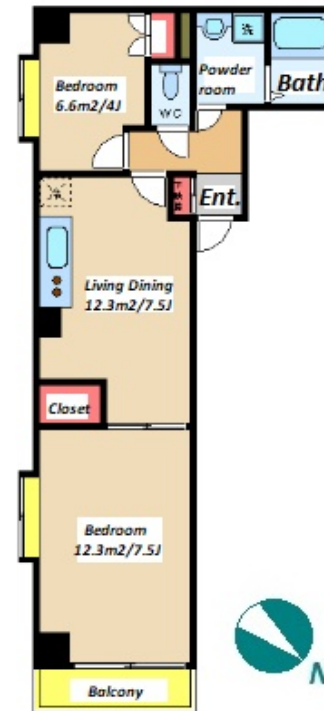

### Lease Conditions

LAYOUT	2 BR	
SIZE	47.42 m <sup>2</sup> /510.42 ft <sup>2</sup>	
RENT	JPY 174,000 / month	
Management Fee	JPY5,000/month	
Deposit	2 months	Key Money 1 month
Lease Term	Fixed term lease for 24 months	
Available	Now	
Renewal Fee	-	
Agent Fee	1 month + tax	
Other Info	Key Replacement Fee : JPY15,000 Tax not included / Guarantor Company : TBC / Air-Con / Separated Toilet / Balcony / Internet (Extra Charge)	

### Building Information

Completion	Nov, 1986	Earthquake Resistance	New
Structure	RC, 5 floors above		
Car Parking	N/A		
Bicycle Parking	( Included )		
Music Instrument	-	Pet	N/A
Facilities	Delivery box / Close to Station / Low-rise		

### Remarks

Renters Insurance : Required

\*The actual Layout & Size may differ slightly from this floor plans & pictures.



## HOUSEREP TOKYO INC.

ハウズレップトーキョー株式会社

#301, 1-4-15, Hiroo, Shibuya-ku, Tokyo 150-0012, Japan

+81 (0)3 6427 5860

inquiry@housserep-tokyo.com

Transaction Type : Intermediate

Agent Fee : 1 month + tax

Website : www.housserep-tokyo.com

