

Property Name	COMFORIA SHINJUKU EAST SIDE TOWER	Unit No.	TYPE	Access	Higashishinnjuku Station on Fukutoshin Line (2 min) Higashishinnjuku Station on Oedo Line (2 min) Shinnjukusannchoume Station on Marunouchi Line (4 min)
		928	Apt.		
Address	6-27-29, Shinjuku, Shinjuku-Ku, Tokyo				

## Luxury Tower Residence w/ many facilities in East Side of Shinjuku

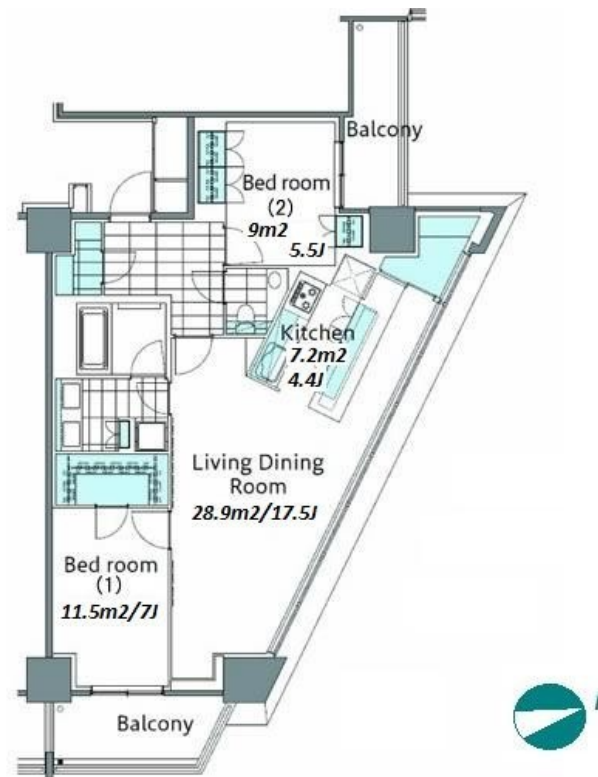

Lease Conditions	
LAYOUT	2 BR
SIZE	85.64 m <sup>2</sup> /921.82 ft <sup>2</sup>
RENT	JPY 558,000 / month
Management Fee	-
Deposit	2 months
Key Money	-
Lease Term	Fixed term lease for 24 months
Available	Now
Renewal Fee	-
Agent Fee	1 month + tax
Other Info	Guarantor Company : TBC / No Key Money / Auto lock / Air-Con / Separated Toilet / Balcony / Flooring / Floor Heating / Dishwasher / Bathroom dryer / WIC / Corner Unit

Building Information	
Completion	Dec, 2011
Earthquake Resistance	New
Structure	RC, 32 floors above
Car Parking	TBC
Bicycle Parking	JPY200 ~ 400/ month
Music Instrument	-
Pet	Negotiable
Facilities	Motorcycle Parking (JPY5,000/ month) / Gym (extra charge) / Within 20 min to Roppongi by train / Near Large Parks / pool / Front desk / Concierge / Delivery box / Elevator / Sky lounge / Security / Close to Station / High-rise

Remarks
Renters Insurance : Required / SOHO: NO / Pet: 3 month Deposit

\*The actual Layout & Size may differ slightly from this floor plans & pictures.



# HOUSEREP TOKYO INC.

ハウスレップトーキョー株式会社

#301, 1-4-15, Hiroo, Shibuya-ku, Tokyo 150-0012, Japan

+81 (0)3 6427 5860

inquiry@housserrep-tokyo.com

Transaction Type : Intermediate

Agent Fee : 1 month + tax

Website : www.housserrep-tokyo.com

